

Crito® CrossBoard

Anschlussmodul 3-polig
 connection module 3-pole
 módulo de conexión 3 polos
 Bornier de raccordement 3P
 Piastra con morsetti di connessione, 3p
 端子排 3线

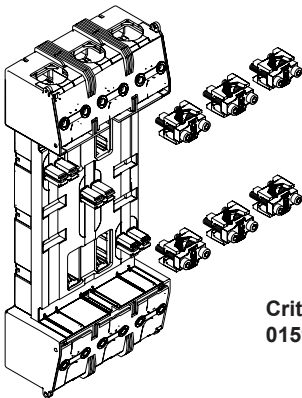

Crito® Anschlussmodul
01594

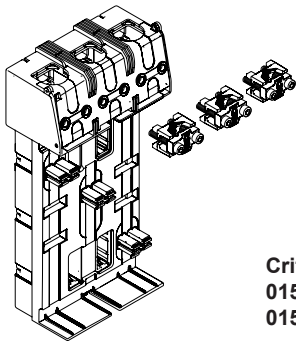

Crito® Anschlussmodul
01595
01591

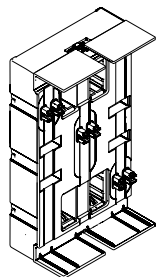

Crito® Befestigungsmodul
01605



Achtung: Vor Installations- oder Servicearbeiten Stromversorgung unterbrechen, um Unfälle zu vermeiden. Die Geräte müssen in einem passenden Gehäuse eingebaut und gegen Verschmutzung geschützt werden. Inbetriebsetzung und Wartung nur durch Fachpersonal!

Attention: To prevent electrical shock, disconnect from power source before installing or servicing. Install in suitable enclosure. Keep free from contaminants. To be commissioned and maintained only by qualified personnel!

Atención: Con el objeto de evitar accidentes, hay que desconectar la alimentación eléctrica antes de realizar el montaje y la puesta en marcha. Debe instalarse en una caja o armario apropiado. Debe protegerse el producto de los ambientes agresivos. La puesta en marcha y el mantenimiento ha de hacerlo exclusivamente por personal especializado!

Attention: Avant le montage et la mise en service, couper l'alimentation secteur afin d'éviter tout accident. Prévoir une mise en coffret ou armoire appropriée, protéger le produit contre les environnements agressifs. Mise en service en entretien: seulement par du personnel spécialisé!

Attenzione: Per prevenire infortuni, togliere tensione prima dell'installazione o manutenzione. Installare in custodia idonea. Tenere lontano da contaminanti. Messa in servizio e manutenzione solo da personale specializzato!

注意: 安装前或检修前应切断电源，以防事故。开关应安装在适合的箱体，同时应做好防污染保护。只有专业人员才能做运行、维护、保养的工作。

Werkzeuge Tools

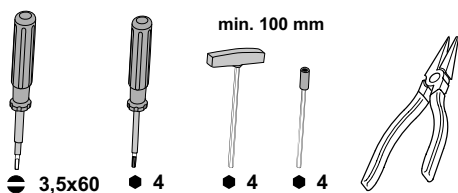

Zubehör Accessoires

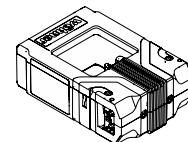
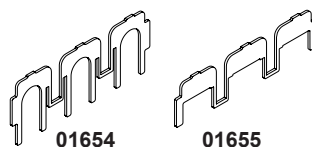

37200 37213
 37201 37219
 37204 37220
 37205 37226
 37208 37232
 37209 37233
 37212 37236

ALLES MIT SPANNUNG

1A. Vorbereitung Crito® auf Montageplatte für CrossBoard®
Preparation of Crito® on mounting plate for CrossBoard®

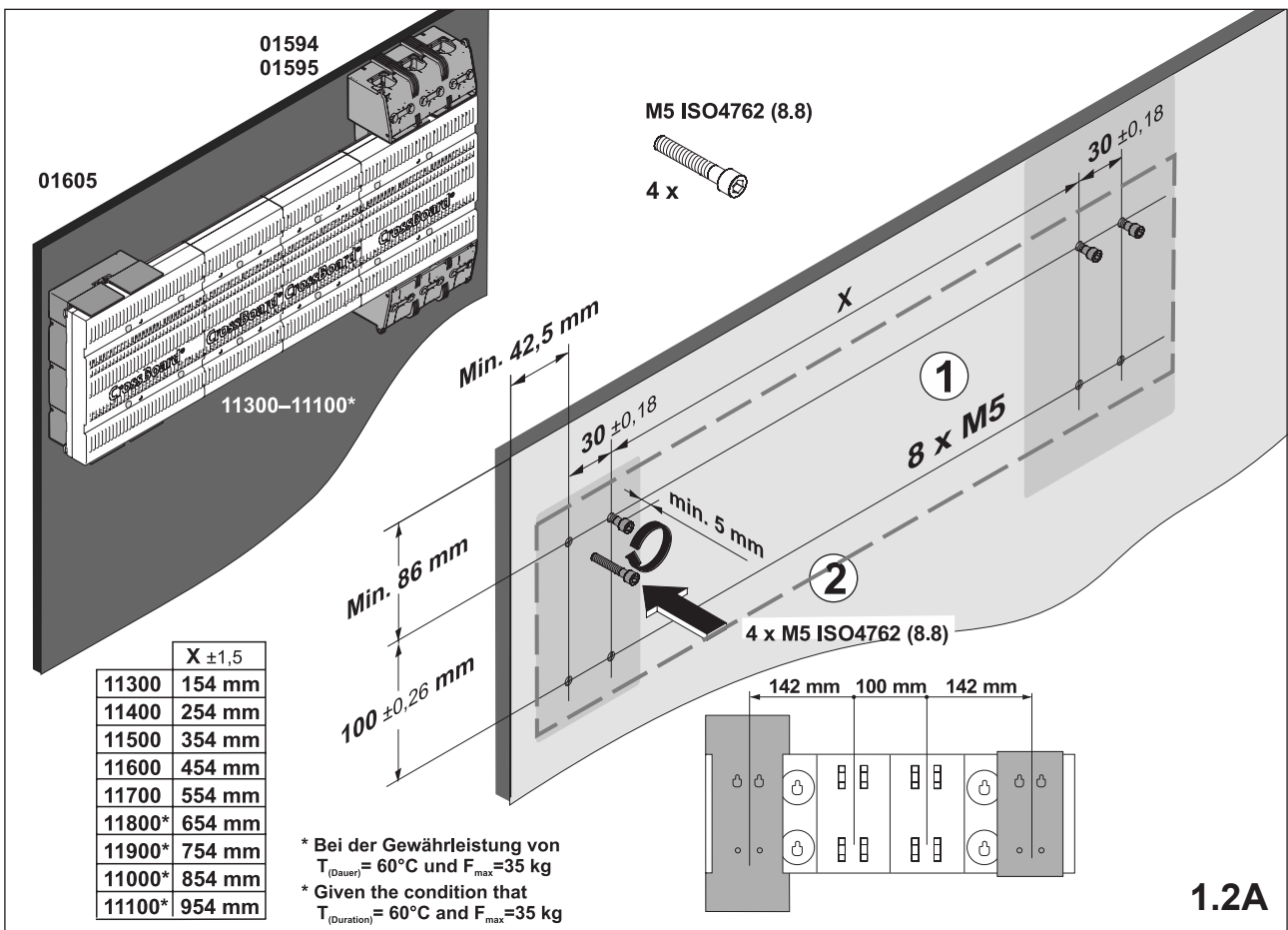
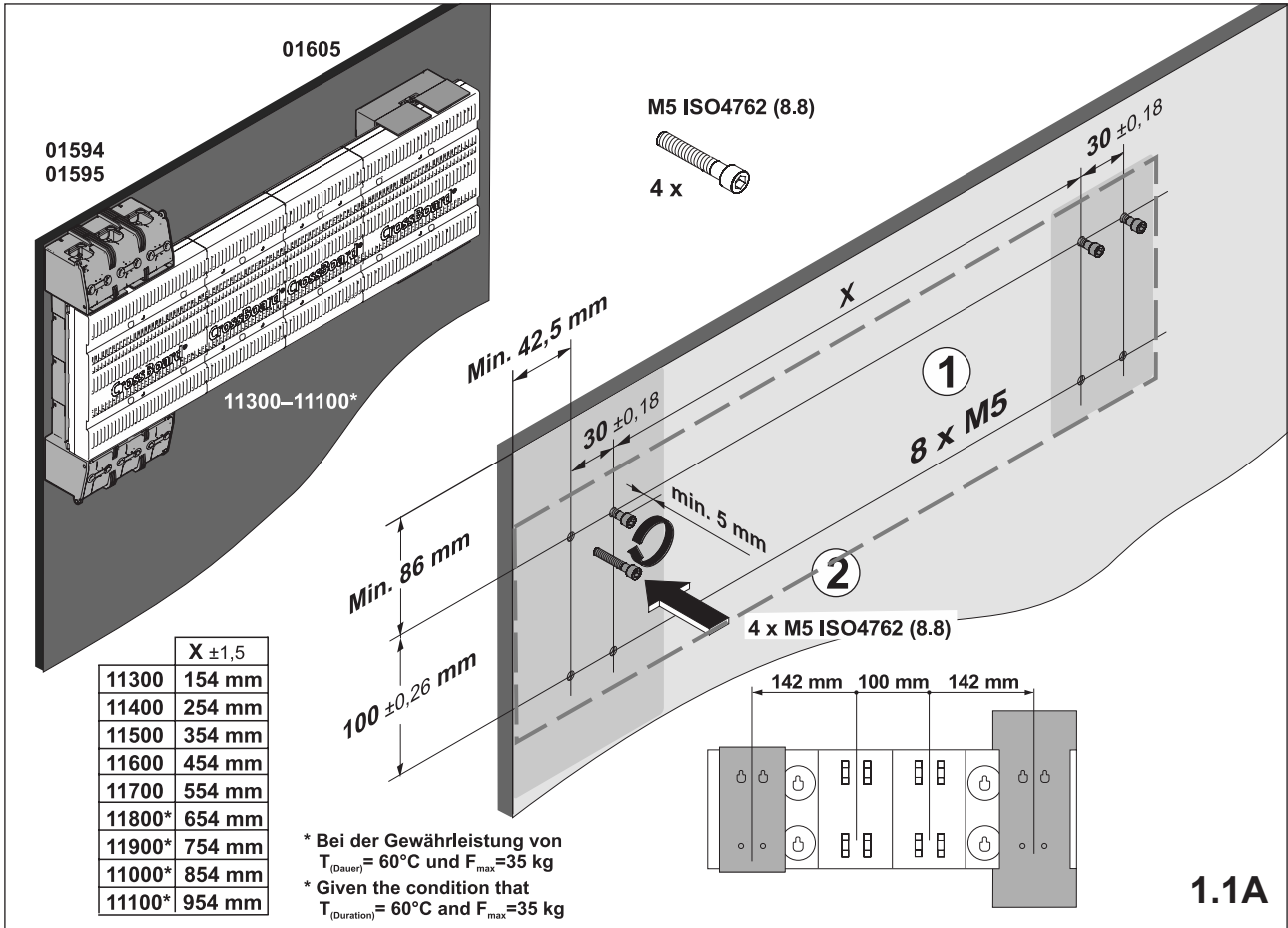

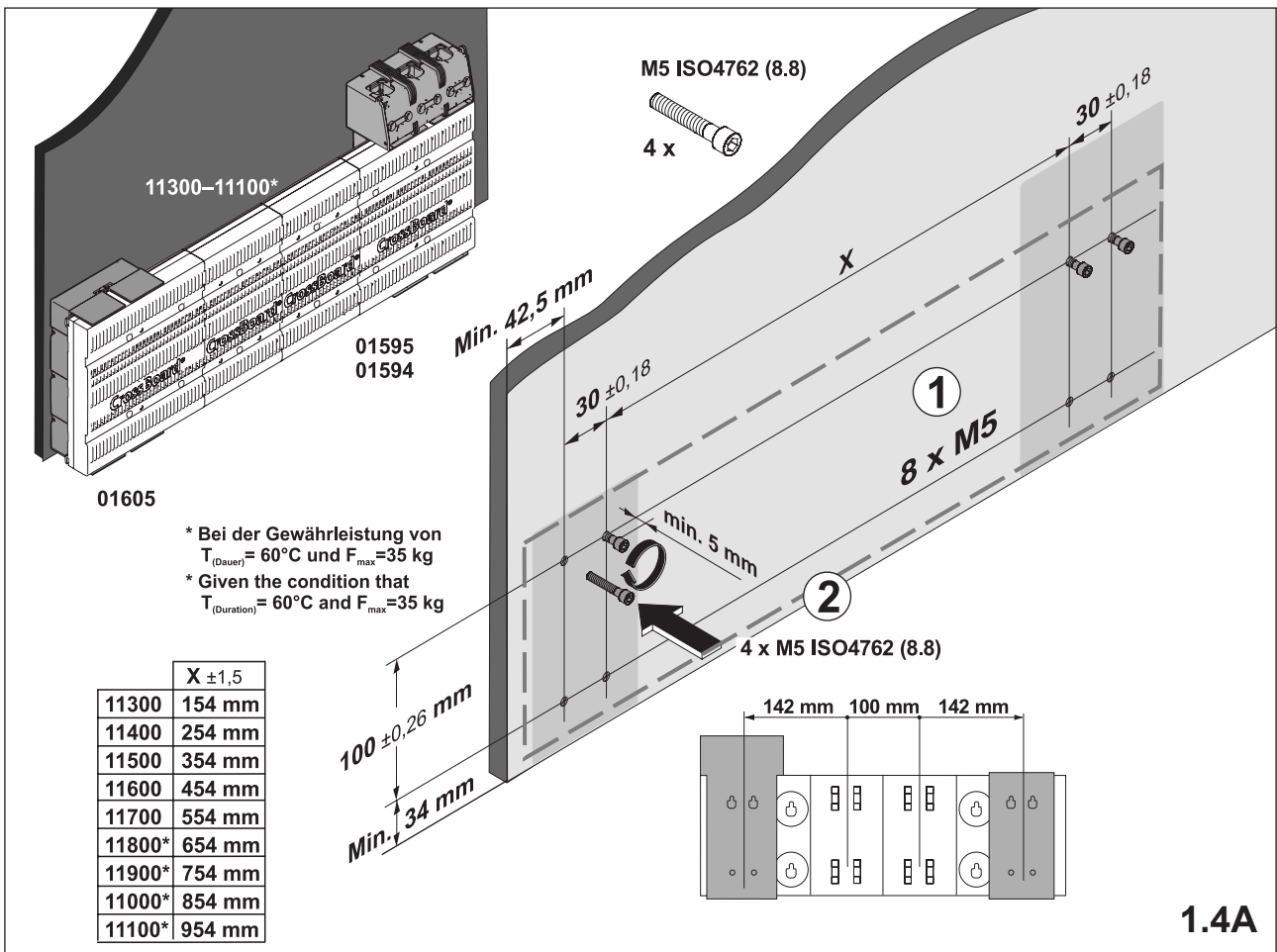
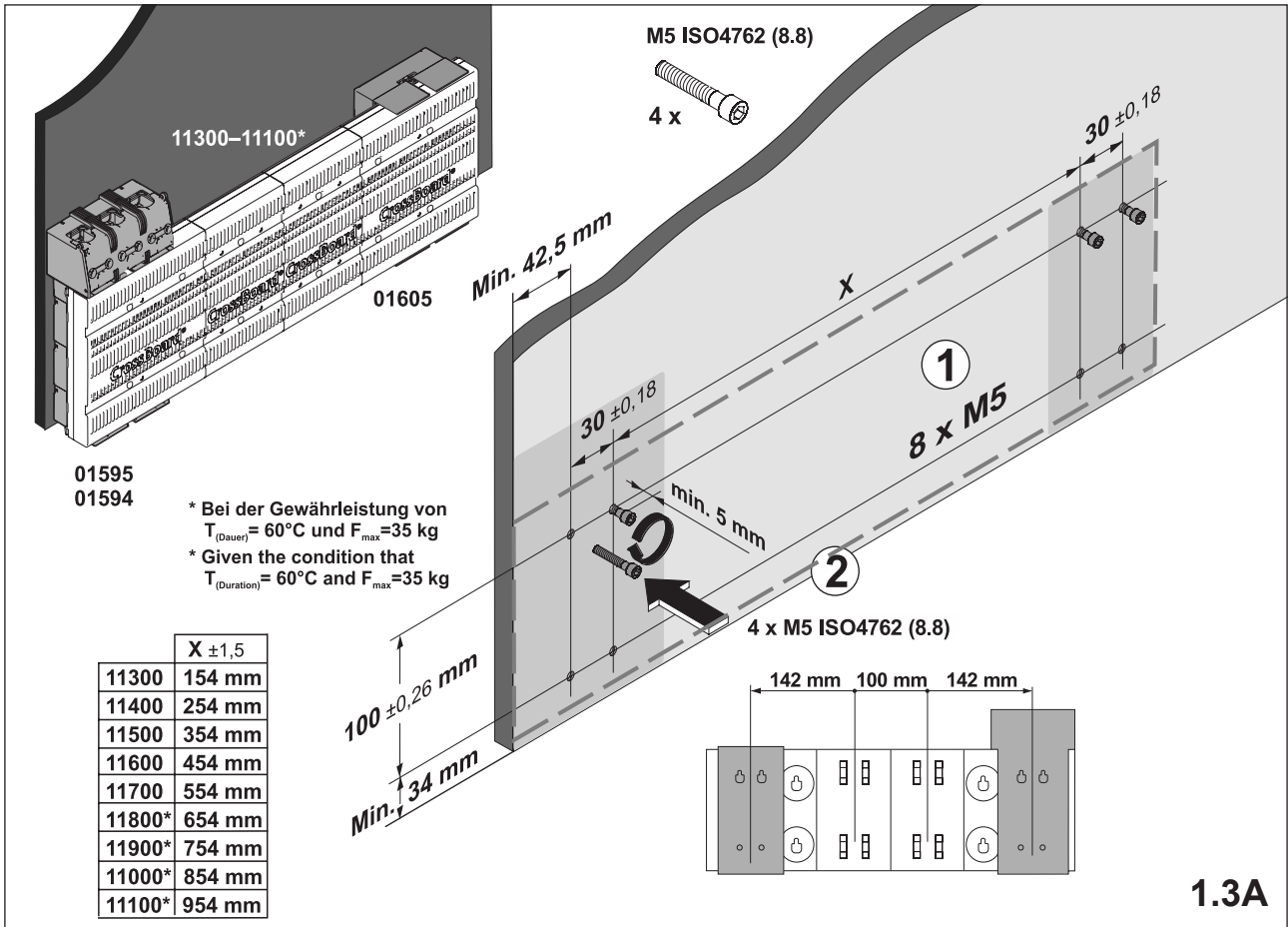

1A. Montage Crito® auf Montageplatte für CrossBoard®
Mounting of Crito® on mounting plate for CrossBoard®

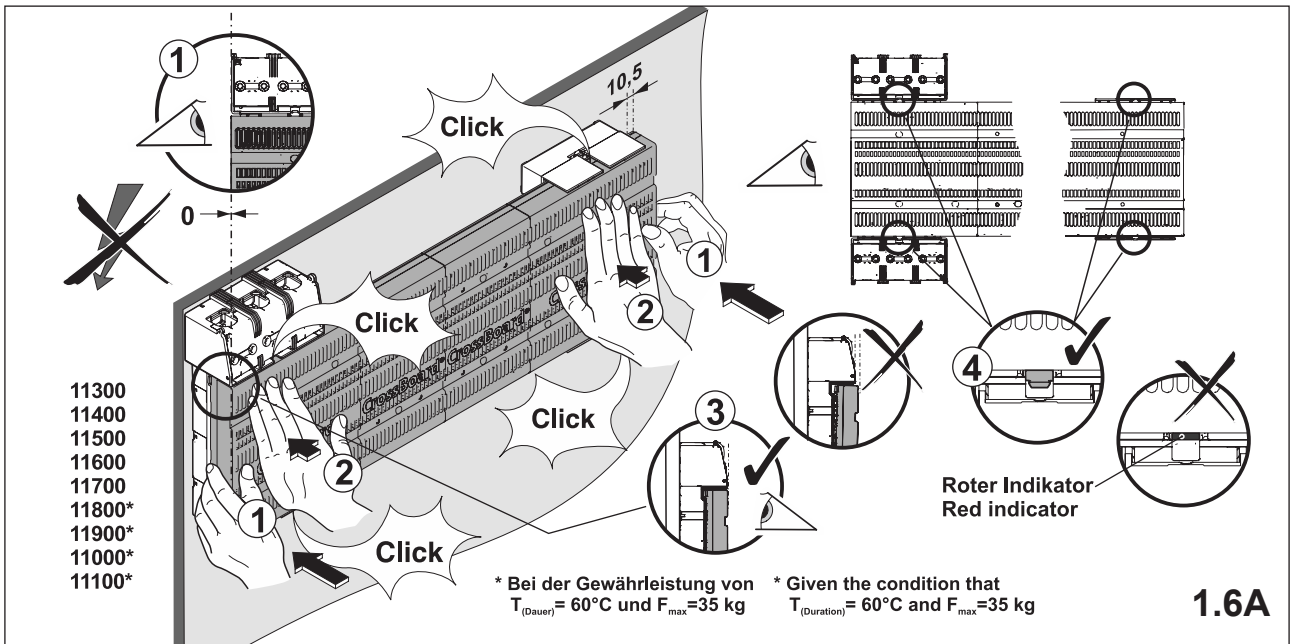
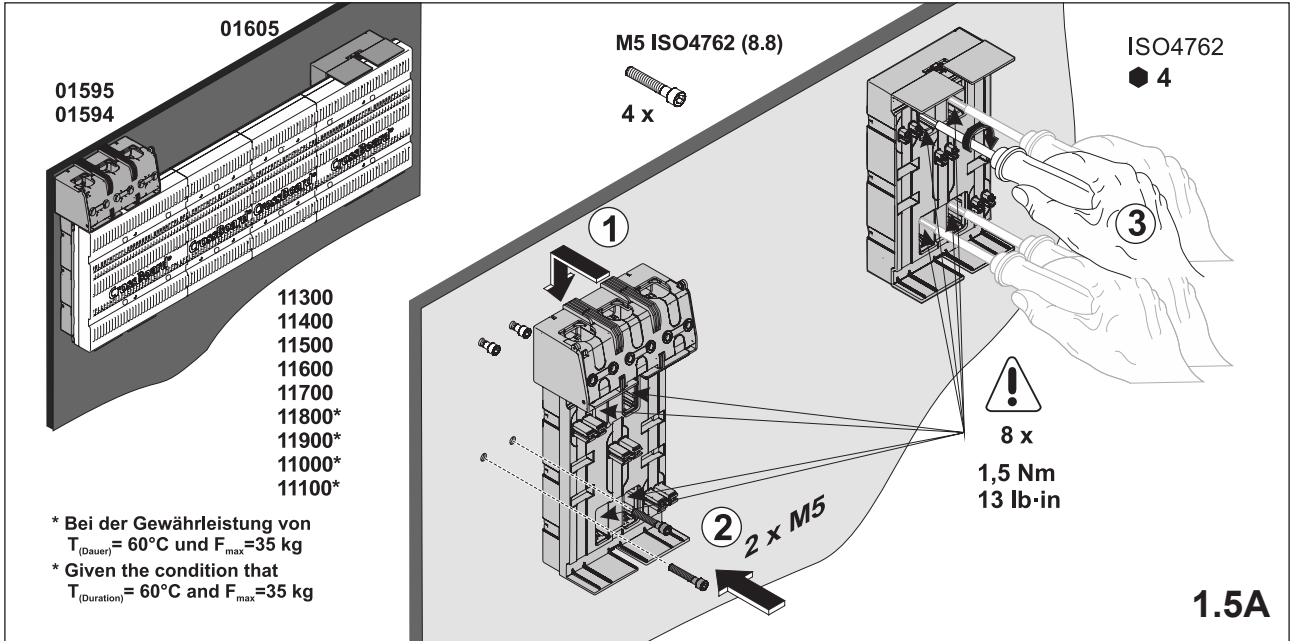

1.1B bis 1.6B nur bei NICHT-Einhaltung der Bedingungen T(Dauer)= 60°C und Fmax=35 kg gültig!
 1.1B bis 1.6B only by FAILURE to comply with the conditions T(Duration)= 60°C and Fmax=35 kg!

1B. Vorbereitung Crito® auf Montageplatte für CrossBoard® 11800, 11900, 11000, 11100
 Preparation of Crito® on mounting plate for CrossBoard® 11800, 11900, 11000, 11100

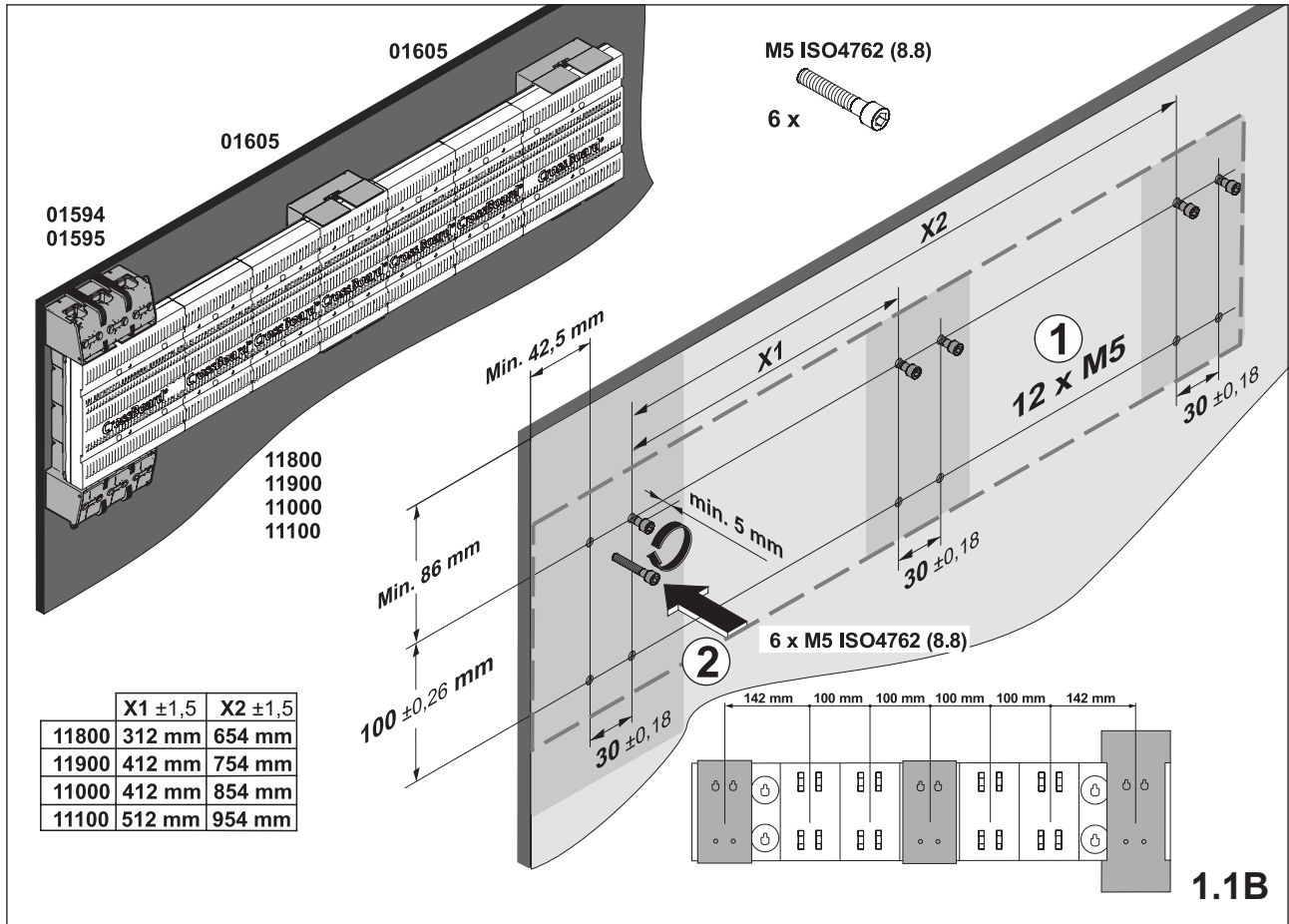

1.1B

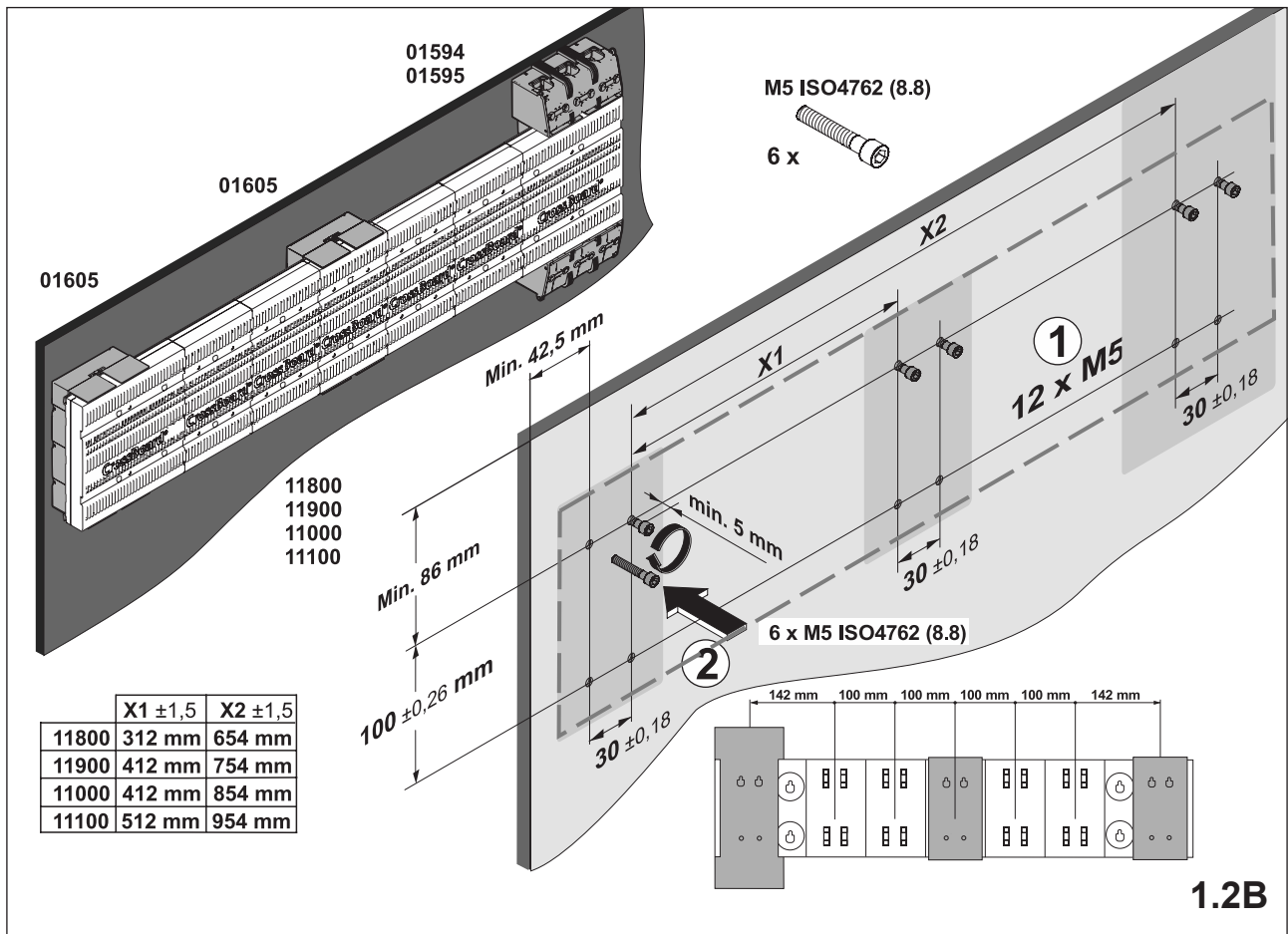

1.2B

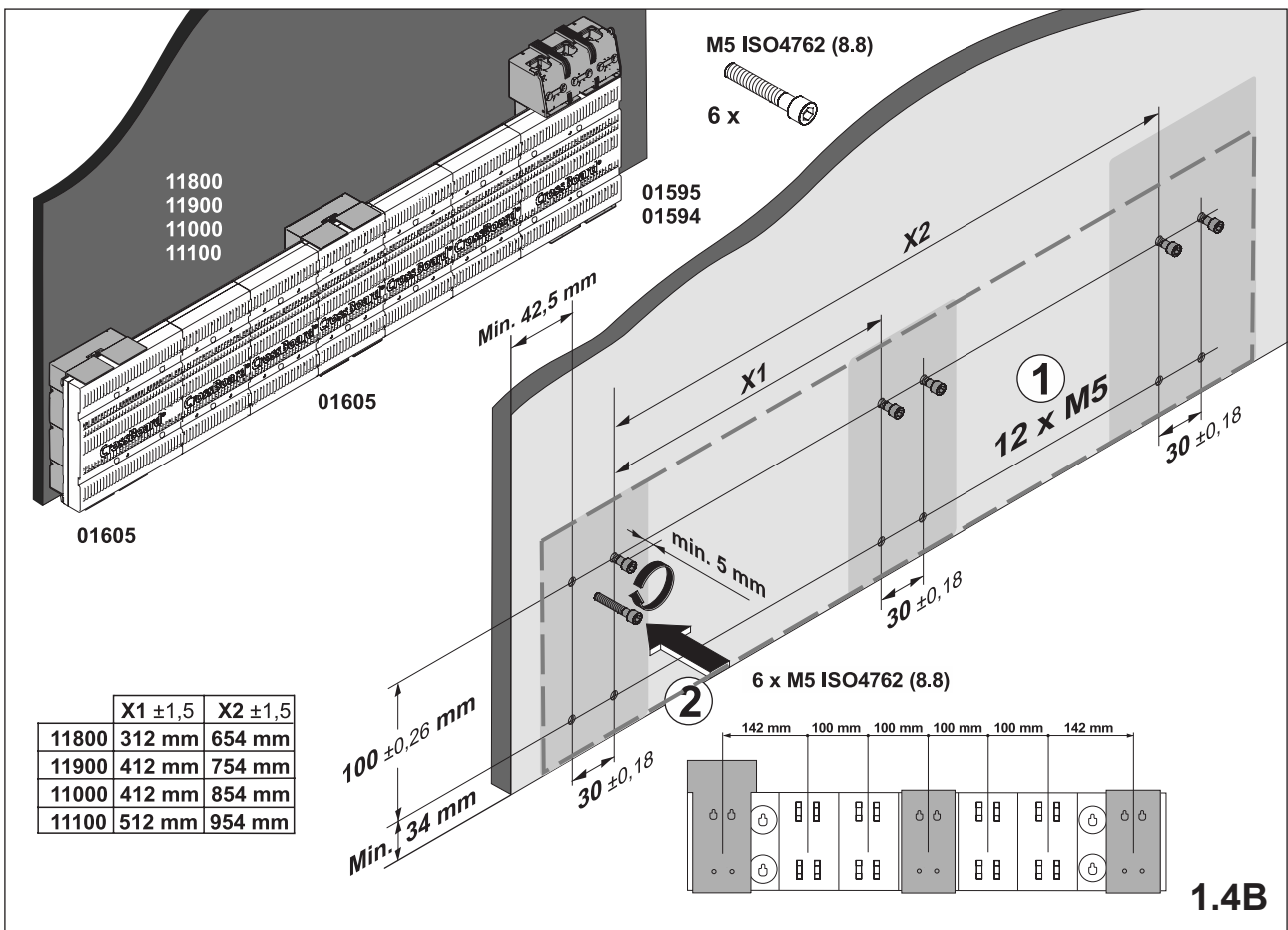
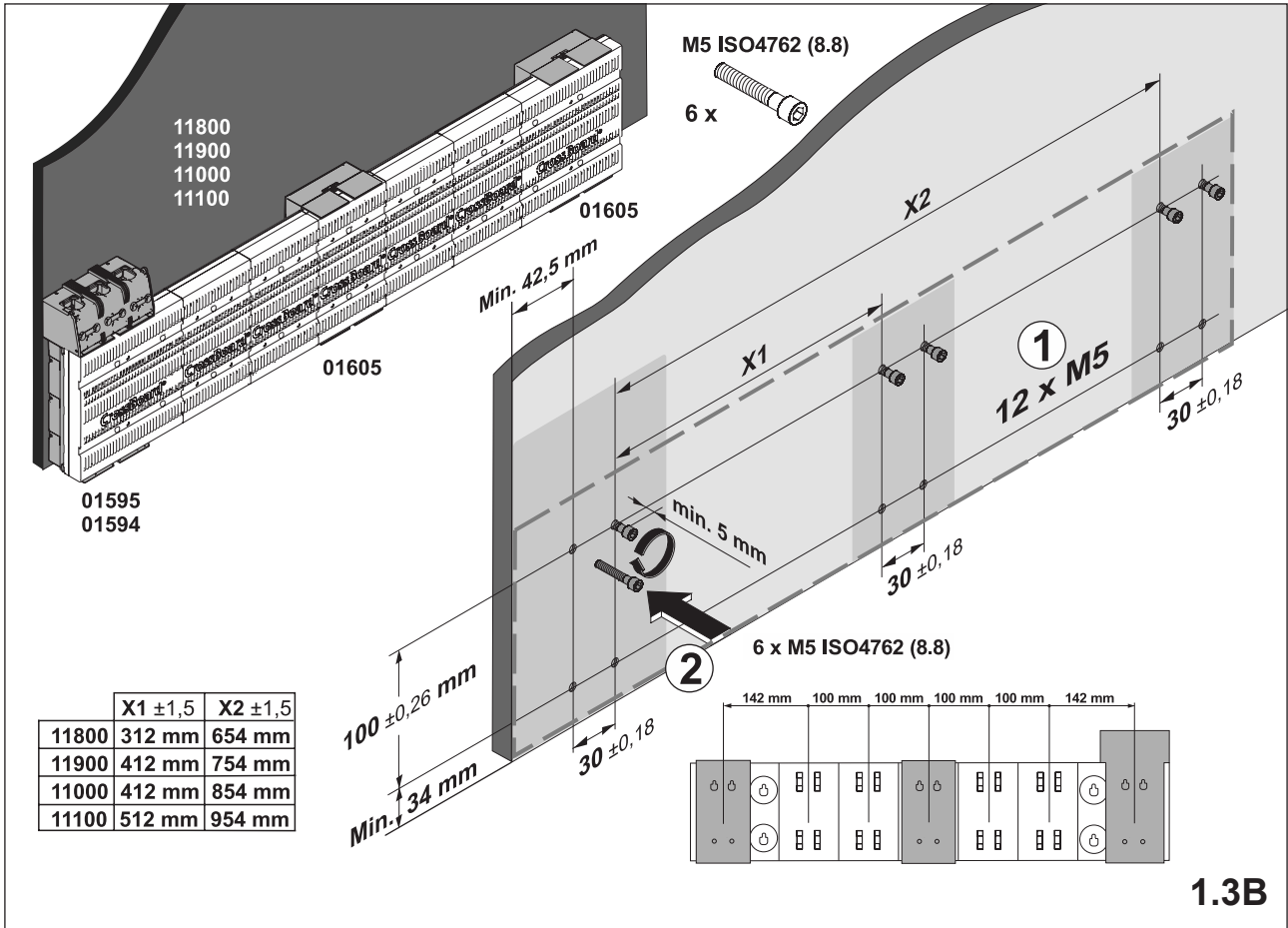

1B. Montage Crito® auf Montageplatte für CrossBoard® 11800, 11900, 11000, 11100
Mounting of Crito® on mounting plate for CrossBoard® 11800, 11900, 11000, 11100

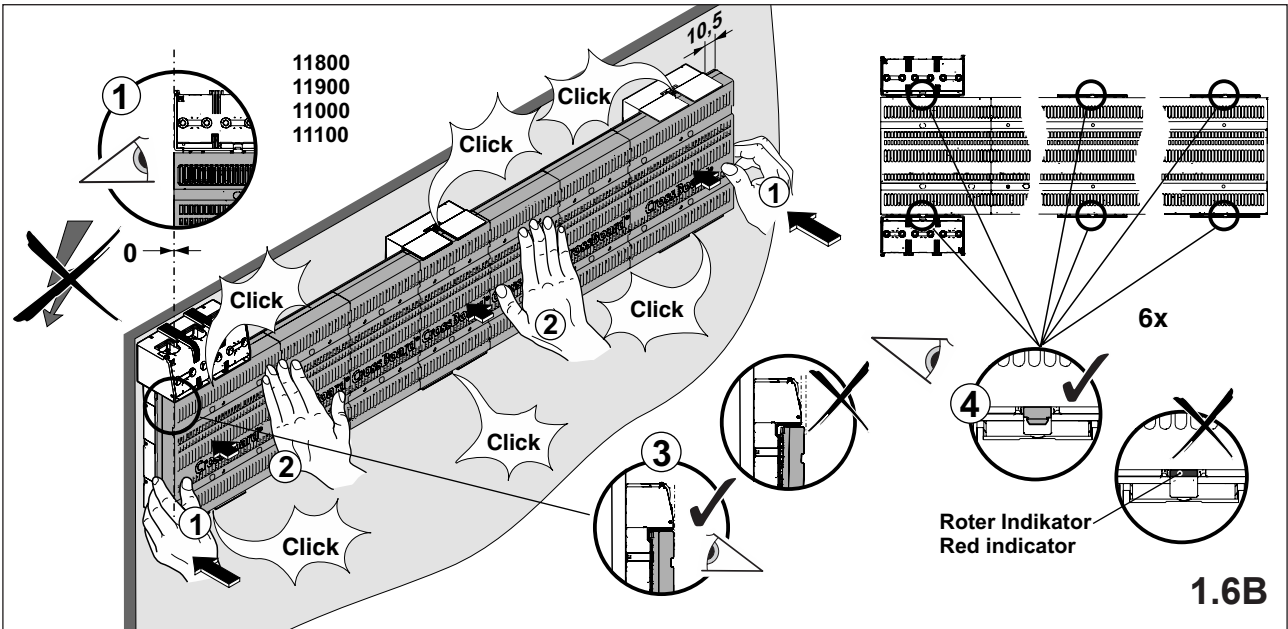
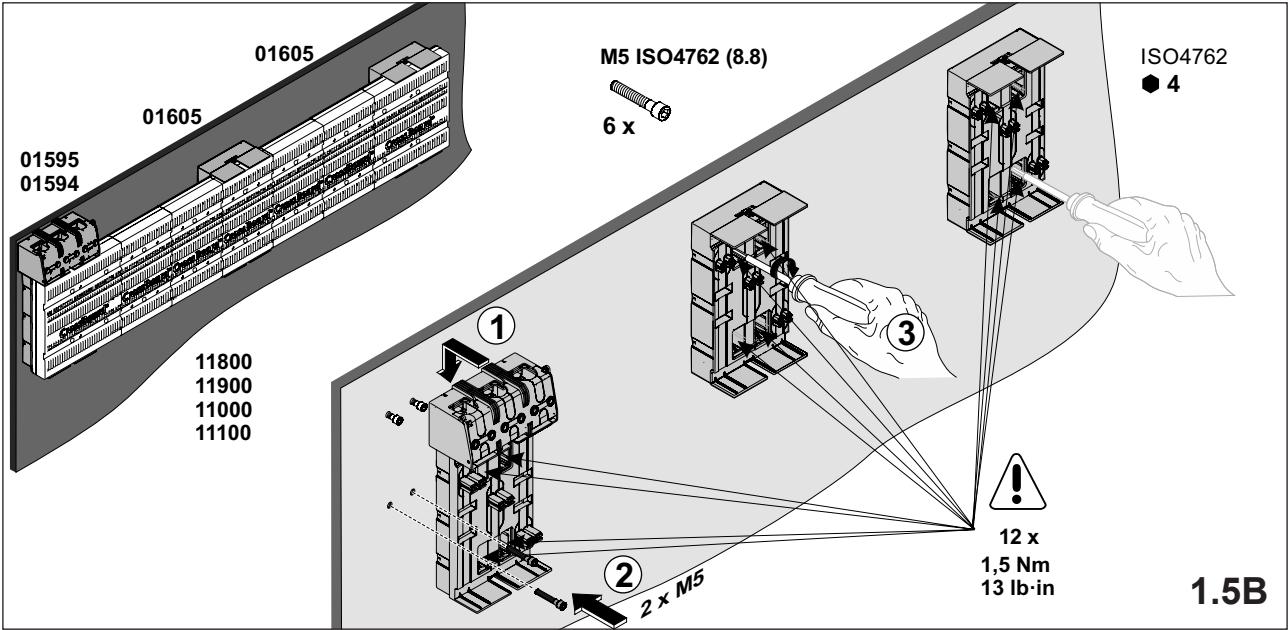

2. Sonderfälle Special cases

2.1 Abgang unten für Crito® 01595

Connection down for Crito® 01595

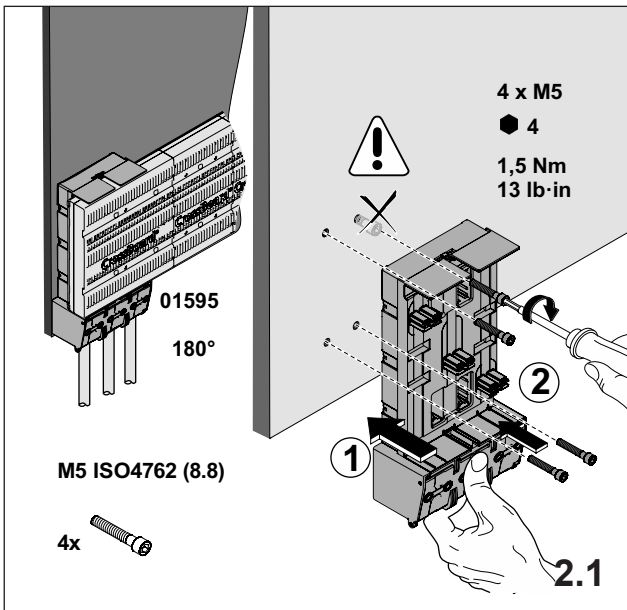

2.2 Alternative Anordnungen für Crito® Alternative arrangements for Crito®

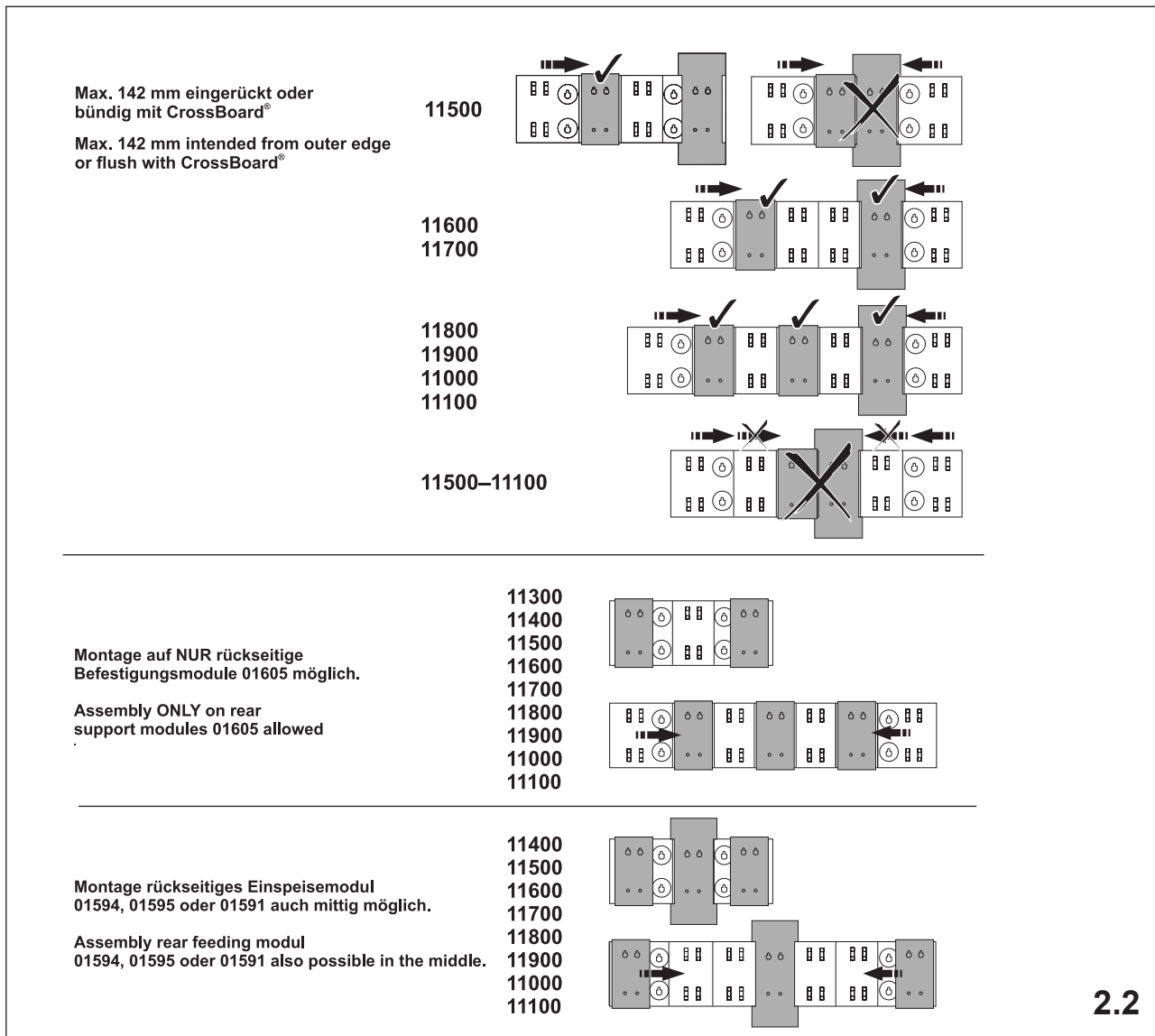

2.3 Durchschleifen für Crito® Loop-through für Crito®

Max. 320 A für Bedingung $T_{(dauer)} = 60^{\circ}\text{C}$ und $F_{max} = 35$ kg.
Andernfalls technischen Support kontaktieren!

Maximum 320 A for conditions $T_{(duration)} = 60^{\circ}\text{C}$ and $F_{max} = 35$ kg.
Otherwise contact technical support!

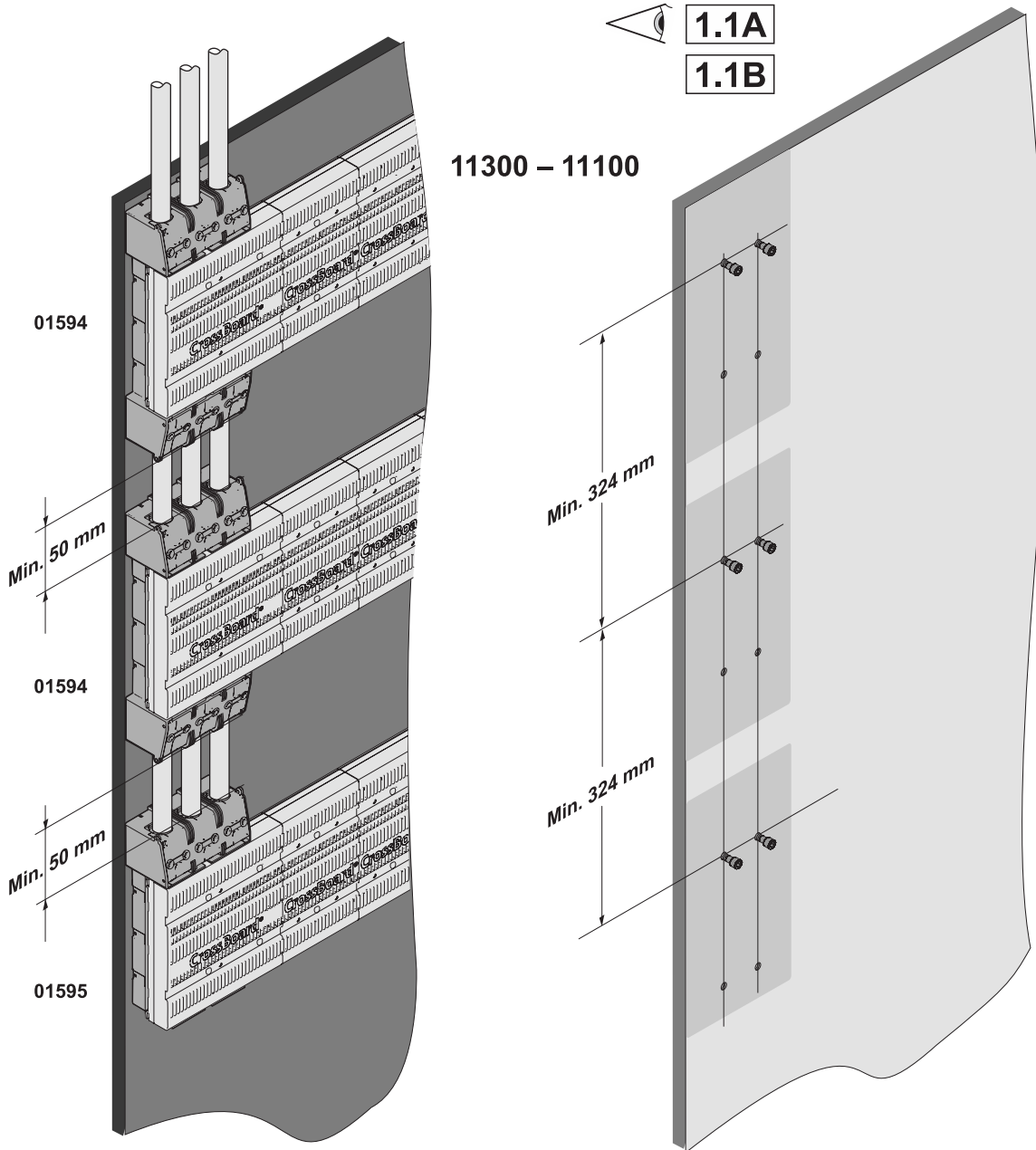

3. Montage Crito® auf Lütze AirSTREAM® für CrossBoard® 11500 – 11100
Mounting of Crito® on Lütze AirSTREAM® for CrossBoard® 11500 – 11100

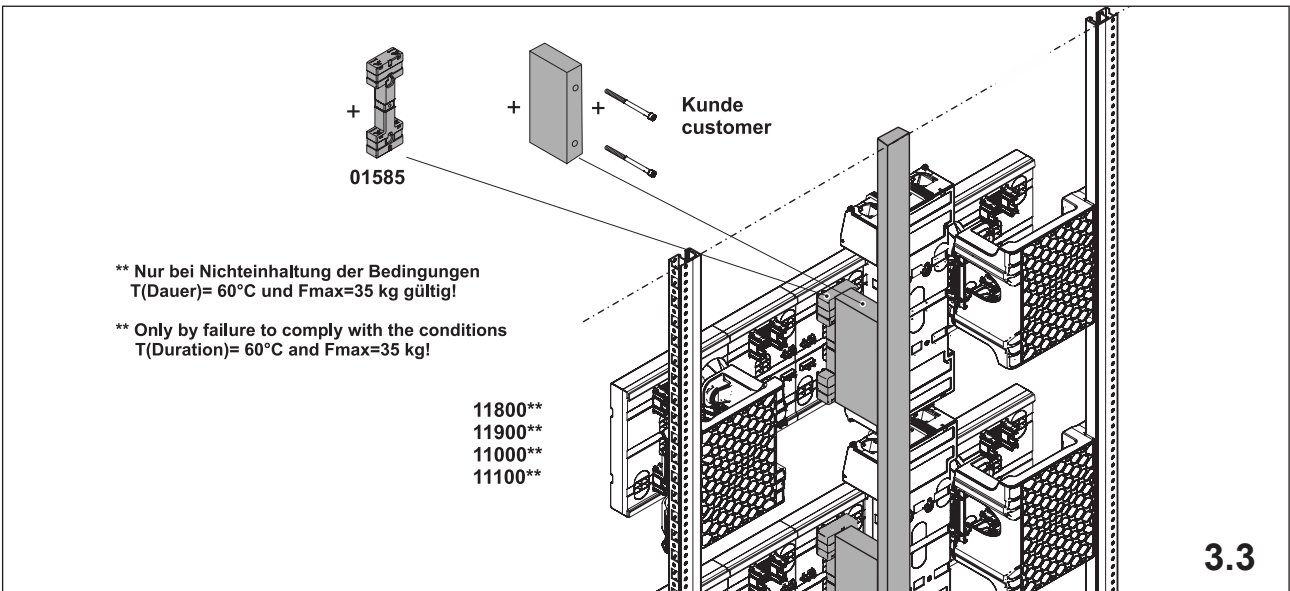
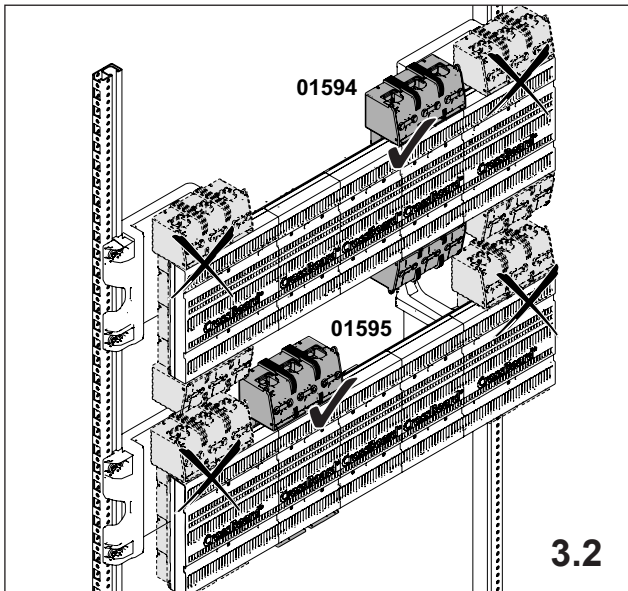
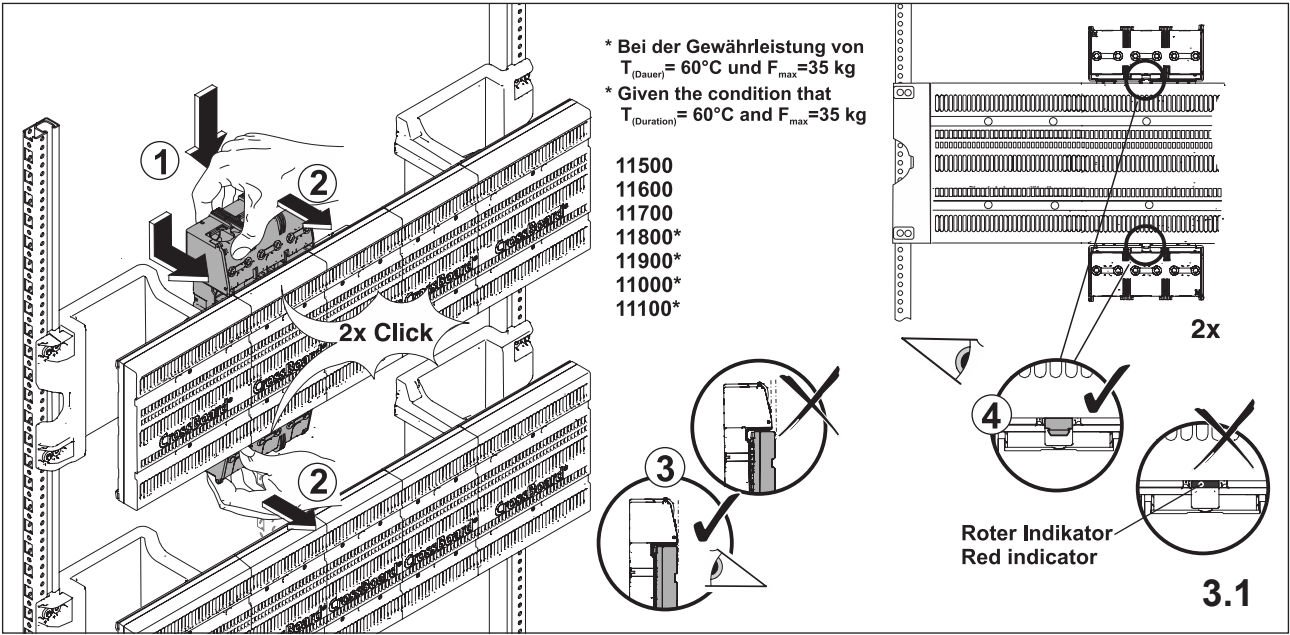

4. Leitungsanschluss Connections

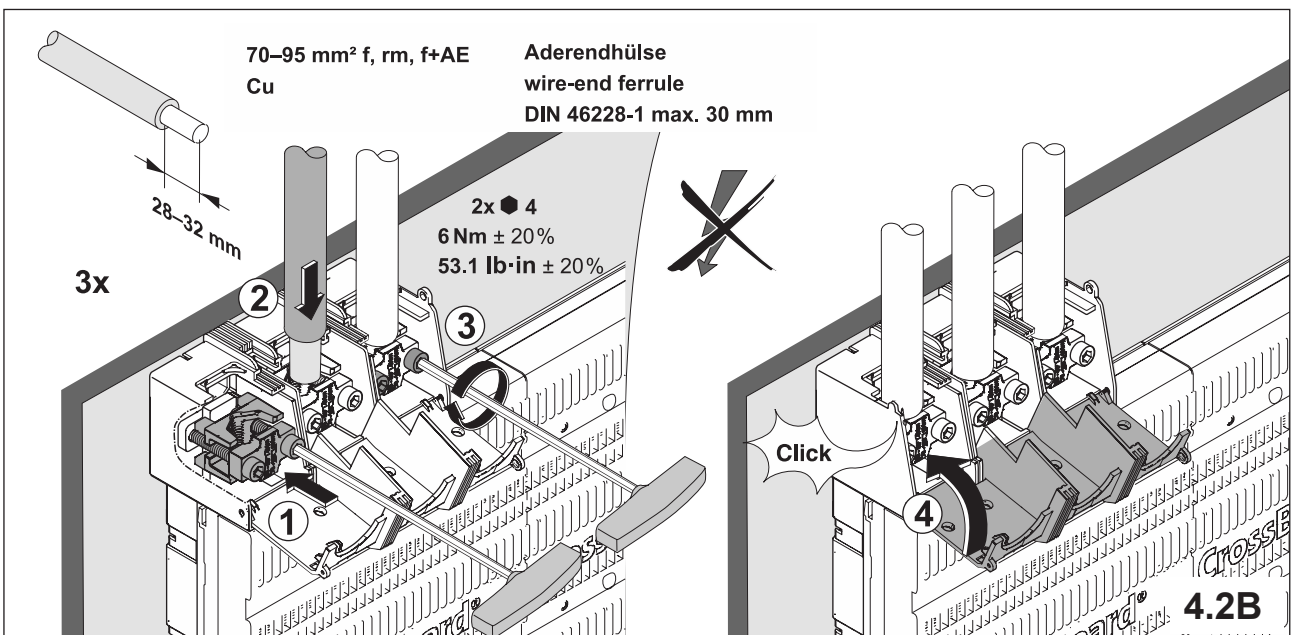
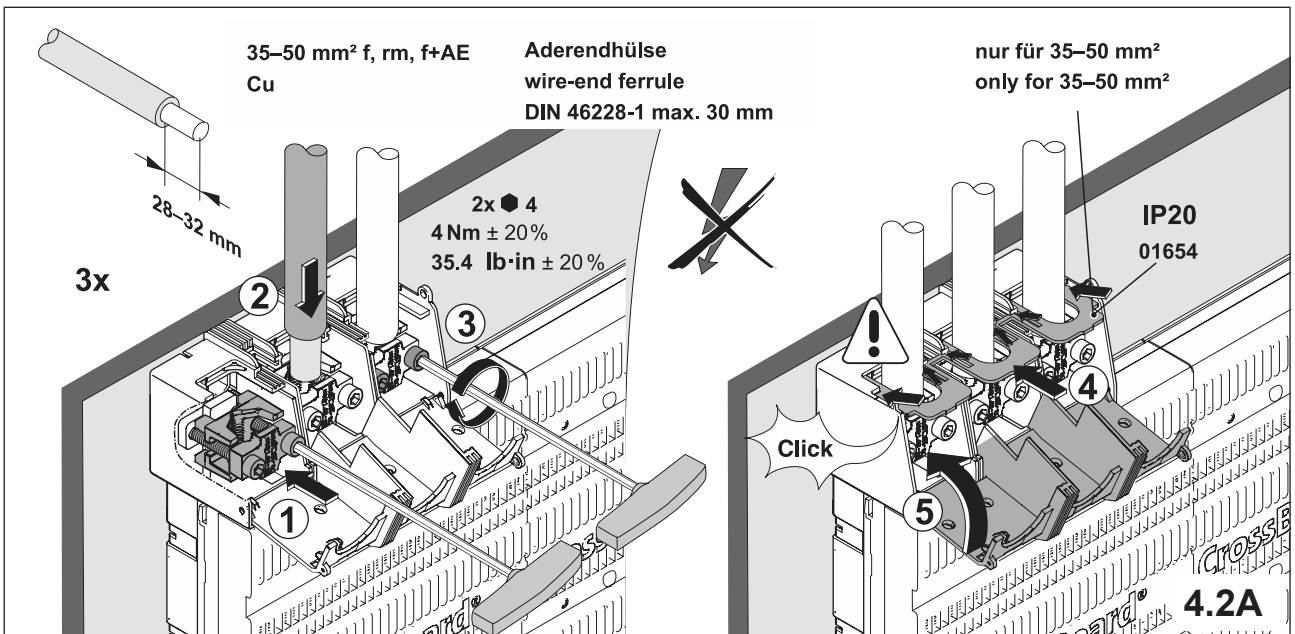
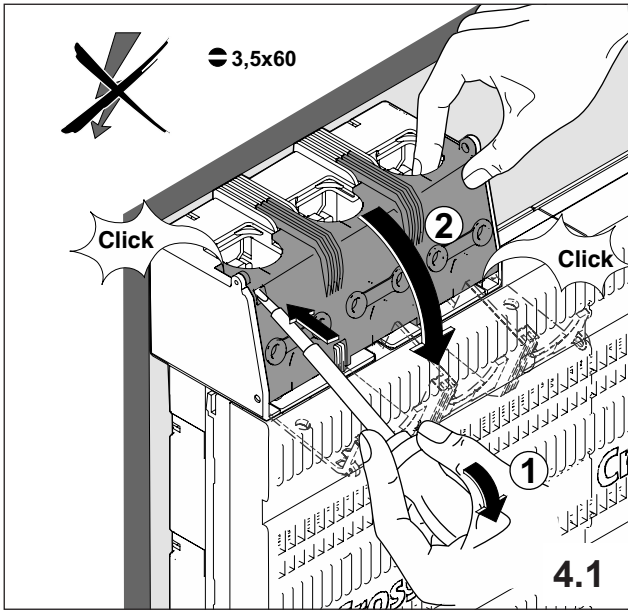

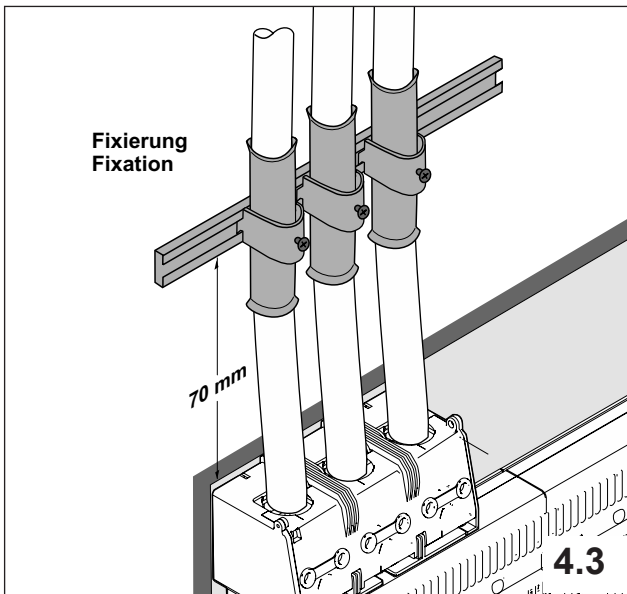
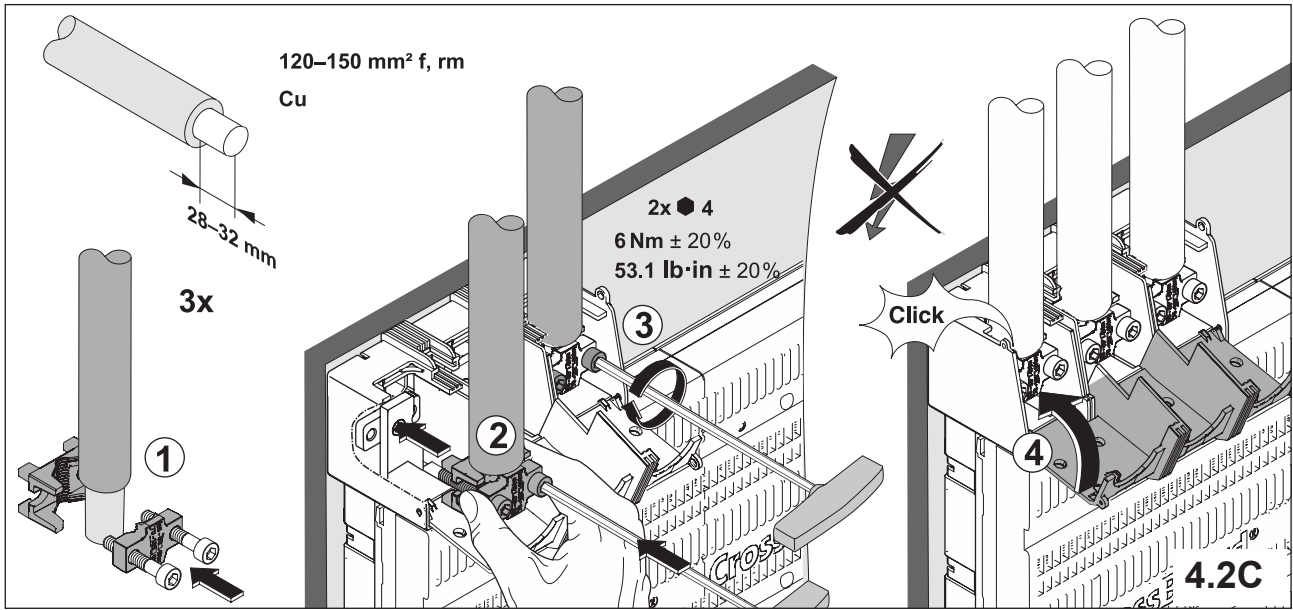

5. Anschluss von Flachleitern Connections of flat conductors

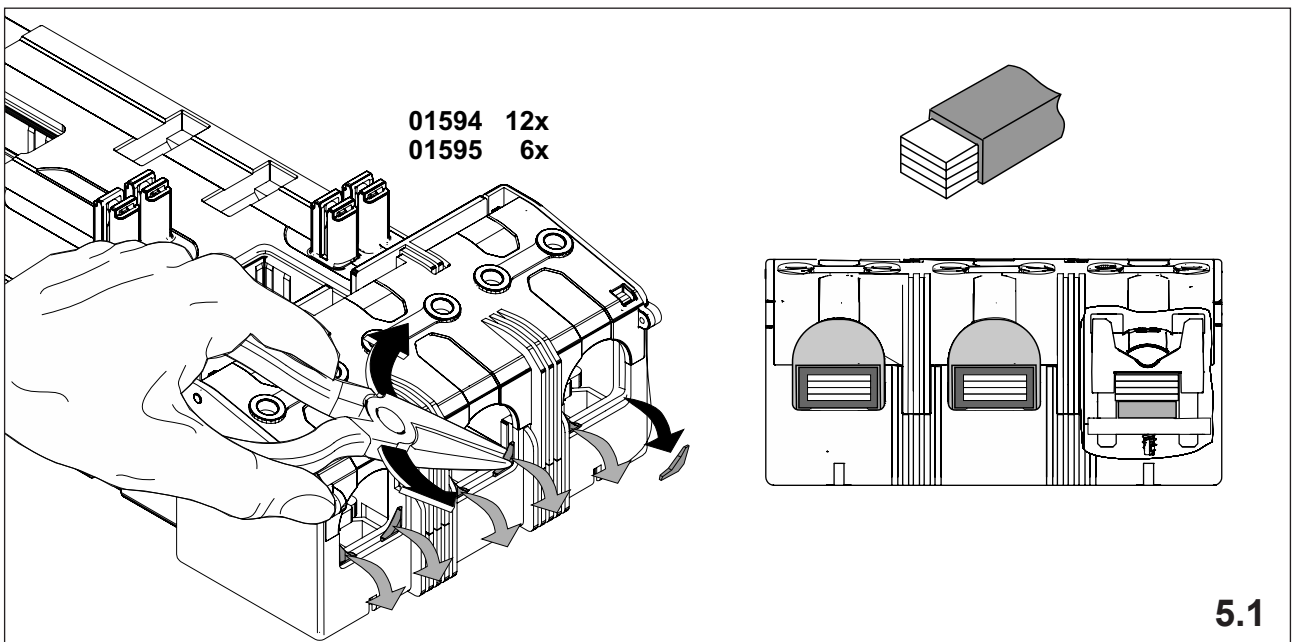

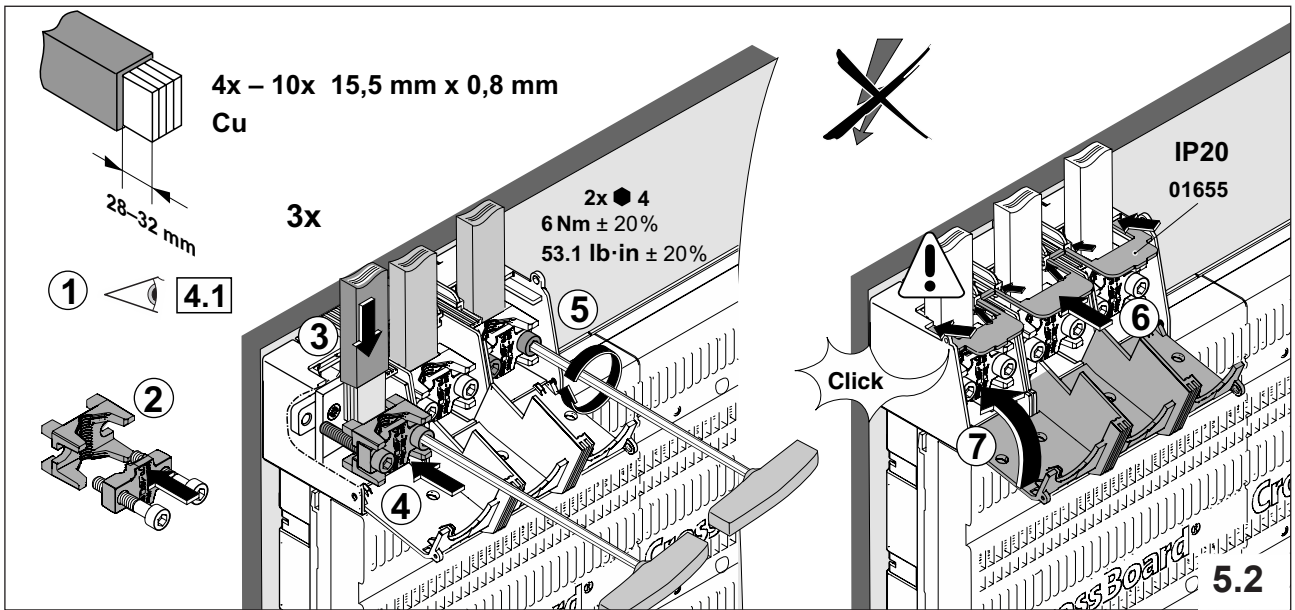

6. Anschluss Stromwandler Assembly current transformer

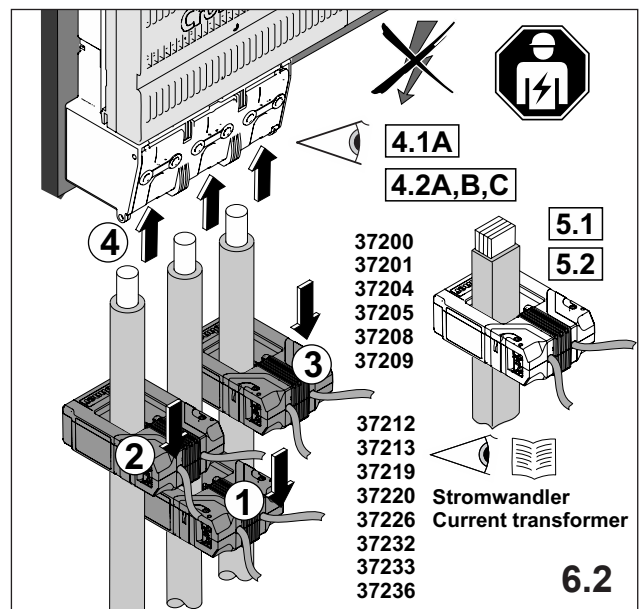
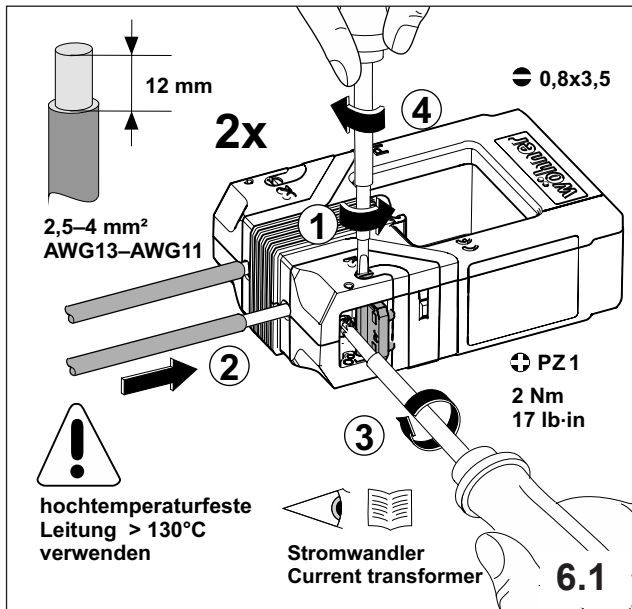

7. Spannungsprüfung Voltage test

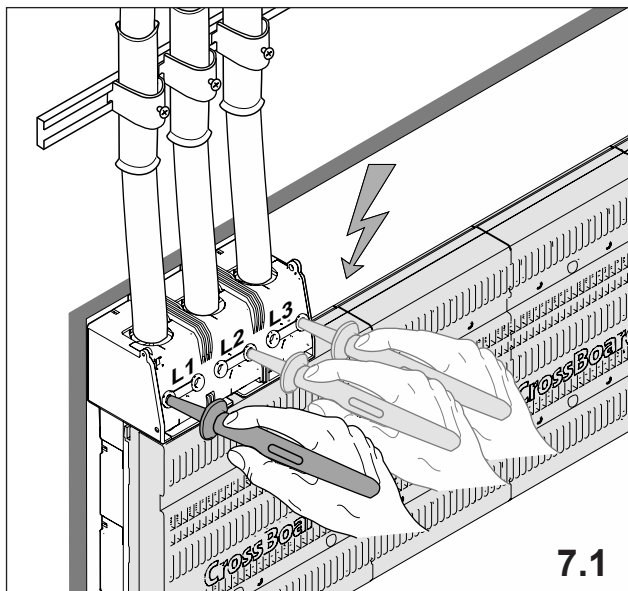

10. Demontage Crito®

Dismounting Crito®

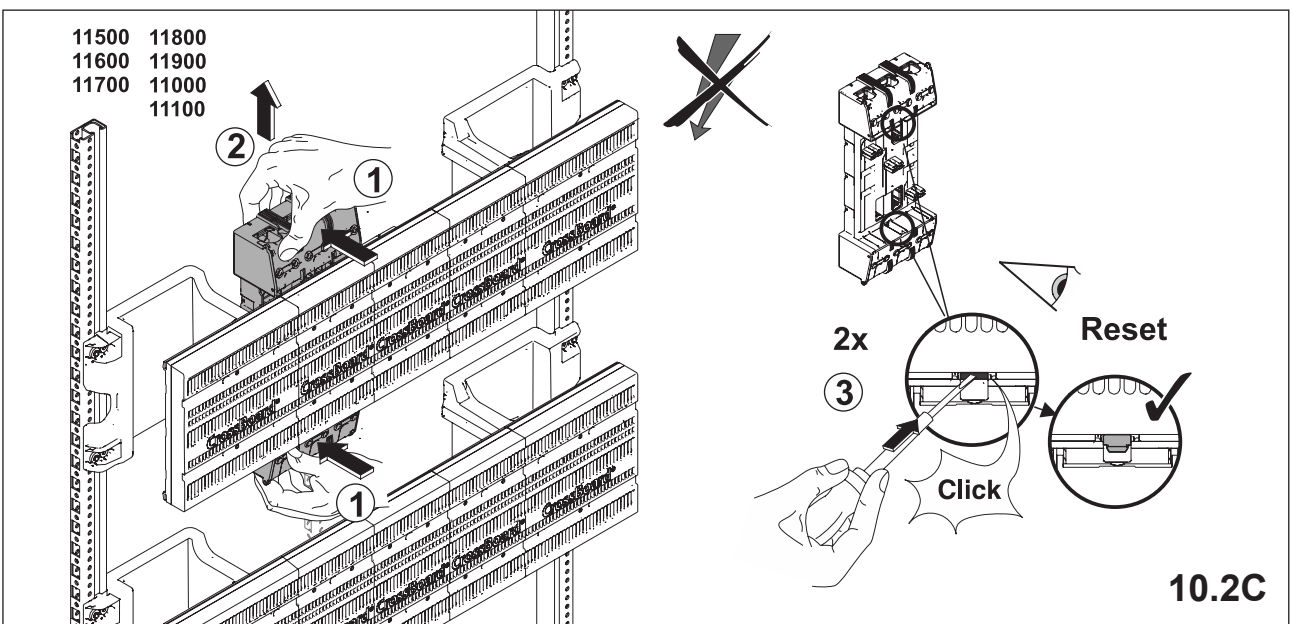
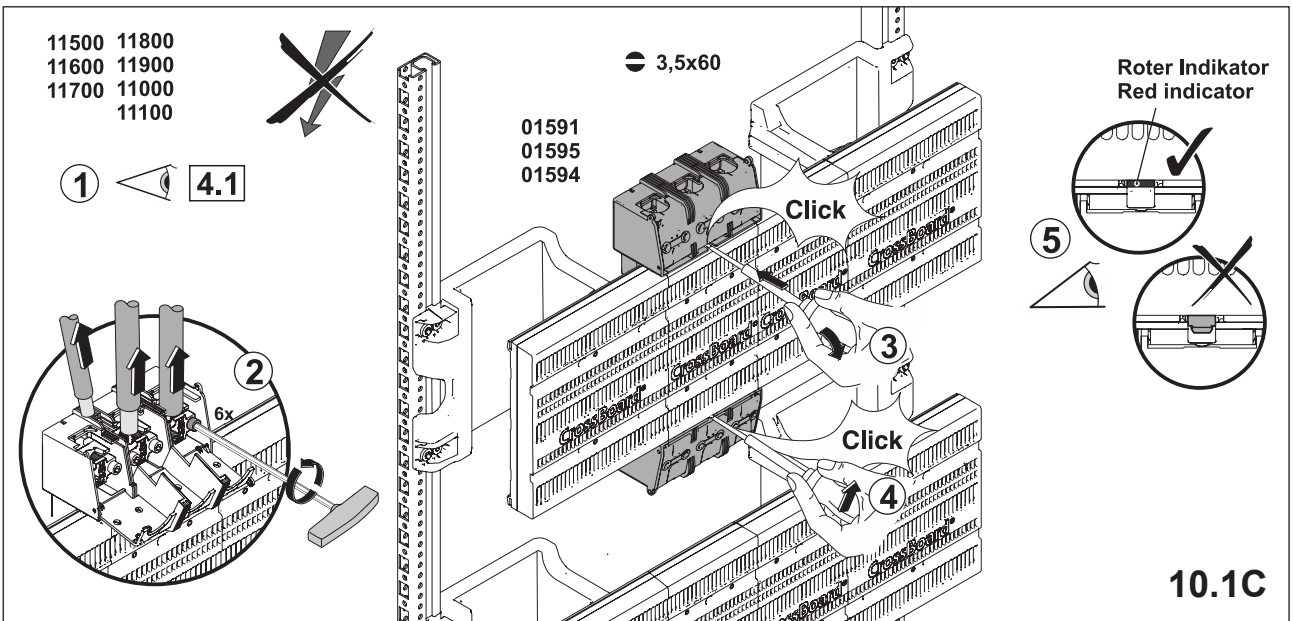
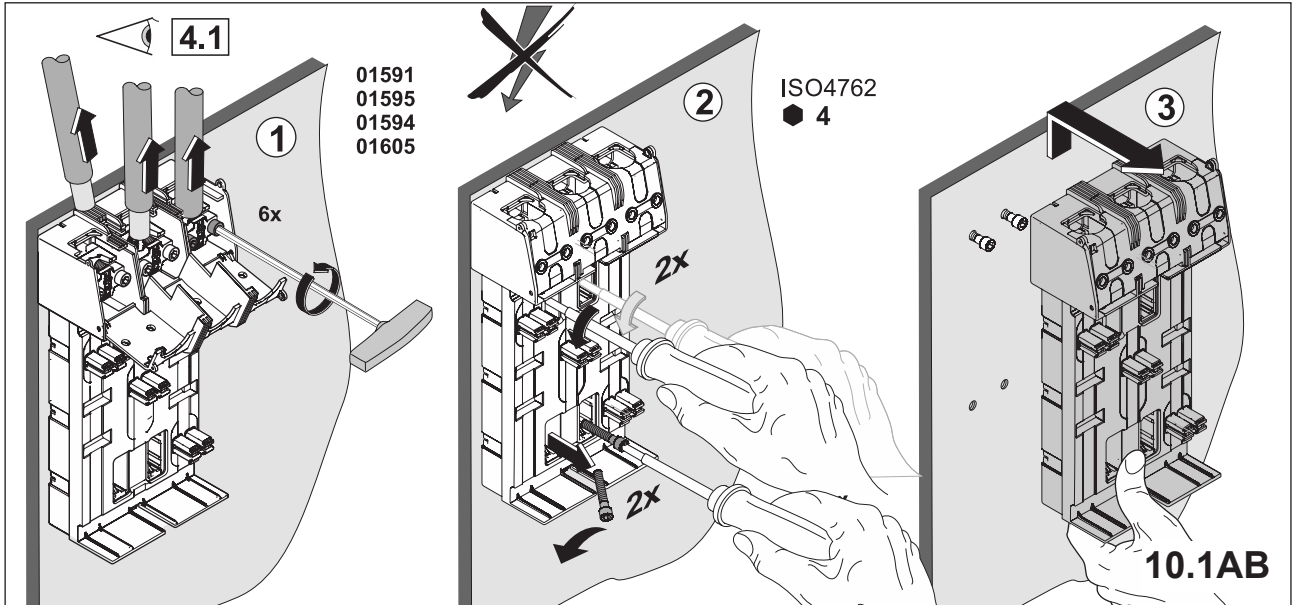

Notizen

Grid of dots for notes.