

SECUR® CrossBoard

Lasttrennschalter mit Sicherungen
 Switch-disconnector-fuse
 Sezionatore sottocarico
 Interruptor-seccionador con fusibles
 seccionador-interruptor-fusivel
 interrupteur-sectionneur à fusibles
 隔离开关熔断器组

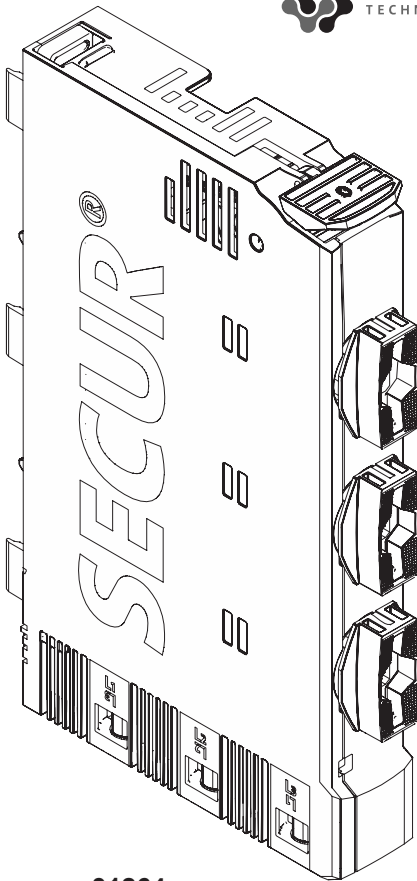

31264
 31664



Achtung: Vor Installations- oder Servicearbeiten Stromversorgung unterbrechen, um Unfälle zu vermeiden. Die Geräte müssen in einem passenden Gehäuse eingebaut und gegen Verschmutzung geschützt werden. Inbetriebsetzung und Wartung nur durch Fachpersonal!

Attention: To prevent electrical shock, disconnect from power source before installing or servicing. Install in suitable enclosure. Keep free from contaminants. To be commissioned and maintained only by qualified personnel!

Atención: Con el objeto de evitar accidentes, hay que desconectar la alimentación eléctrica antes de realizar el montaje y la puesta en marcha. Debe instalarse en una caja o armario apropiado. Debe protegerse el producto de los ambientes agresivos. La puesta en marcha y el mantenimiento ha de hacerlo exclusivamente por personal especializado!

Attention: Avant le montage et la mise en service, couper l'alimentation secteur afin d'éviter tout accident. Prévoir une mise en coffret ou armoire appropriée, protéger le produit contre les environnements agressifs. Mise en service et entretien: seulement par du personnel spécialisé!

Attenzione: Per prevenire infortuni, togliere tensione prima dell'installazione o manutenzione. Installare in custodia idonea. Tenere lontano da contaminanti. Messa in servizio e manutenzione solo da personale specializzato!

注意: 安装前或检修前应切断电源，以防事故。开关应安装在适合的箱体，同时应做好防污染保护。只有专业人员才能做运行、维护、保养的工作。

Werkzeuge
Tools



Zubehör
Accessoires

Class CC Sicherungen / Class CC fuses

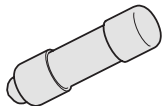

31394	31398	31250	31067	31078
31244	31247	31251	31068	31079
31395	31022	31252	31069	31080
31245	31399	31032	31074	
31396	31400	31033	31075	
31397	31248	31034	31076	
31246	31249	31066	31077	

1. Minimale Gehäuseabmessung
Minimal enclosure dimensions

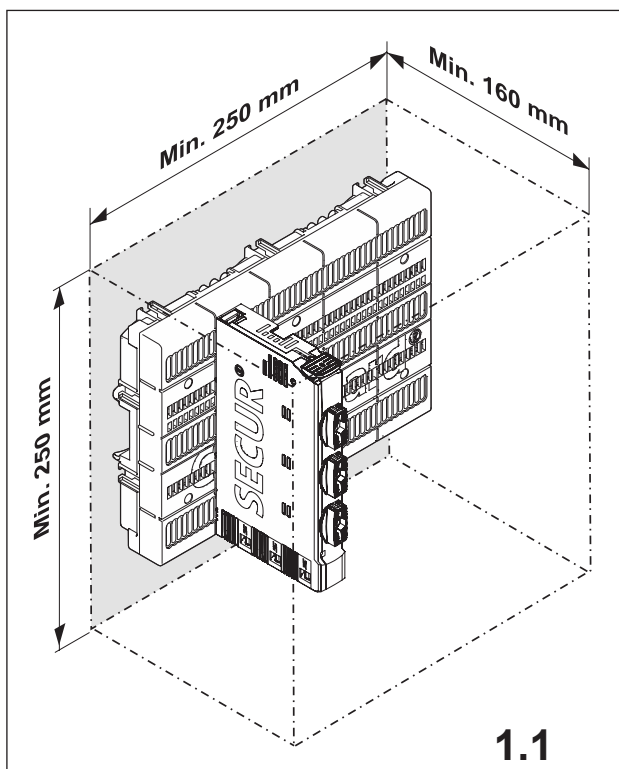

2. Minimaler Abstand zu geerdeten Teilen
Minimal clearance to enclosure or any grounded metal parts

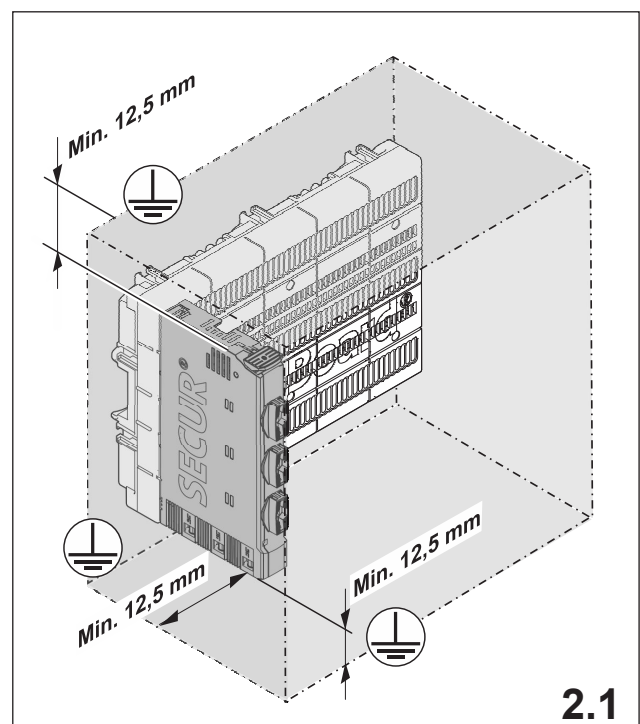

**3. Montage auf CrossBoard®
Mounting on CrossBoard®**

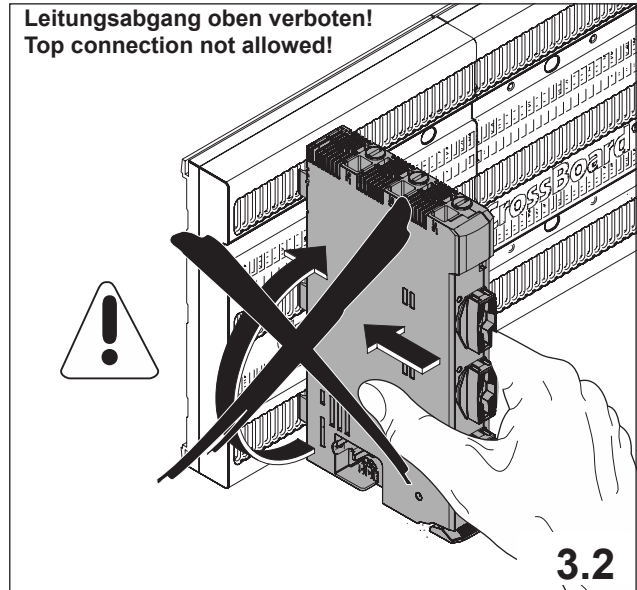
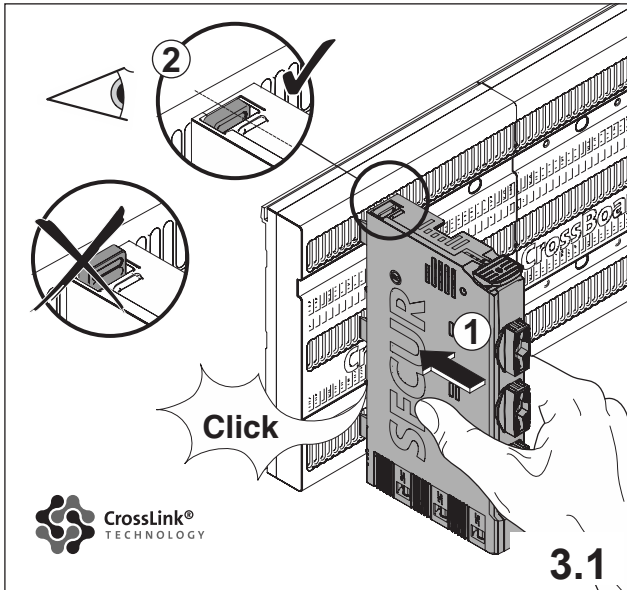

**Montage auf CrossBoard® (Typ CB225-24x7 oder CB405-24x7 – UL File E123577 Vol. 2 Sec. 3)
Mounting on CrossBoard® (Type CB225-24x7 or CB405-24x7 – UL File E123577 Vol. 2 Sec. 3)**

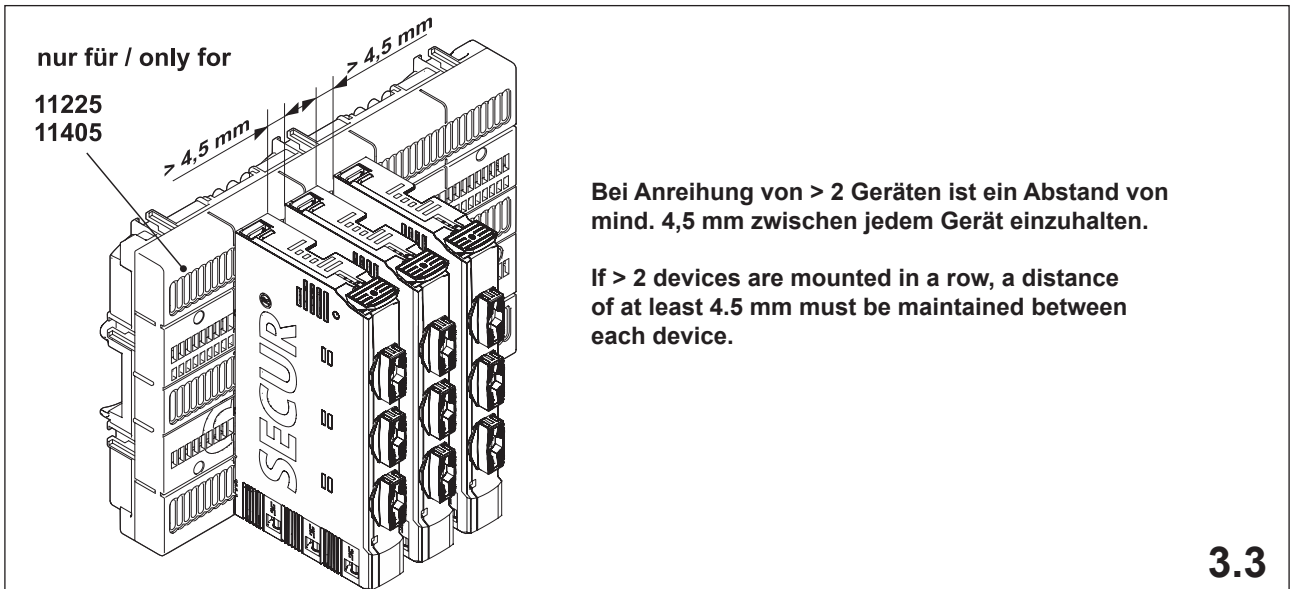

**Montage auf CrossBoard® (Typ CB-XL-...-24x16 oder CB-800-XXX – UL File E123577 Vol. 2 Sec. 4)
Mounting on CrossBoard® (Type CB-XL-...-24x16 or CB-800-XXX – UL File E123577 Vol. 2 Sec. 4)**

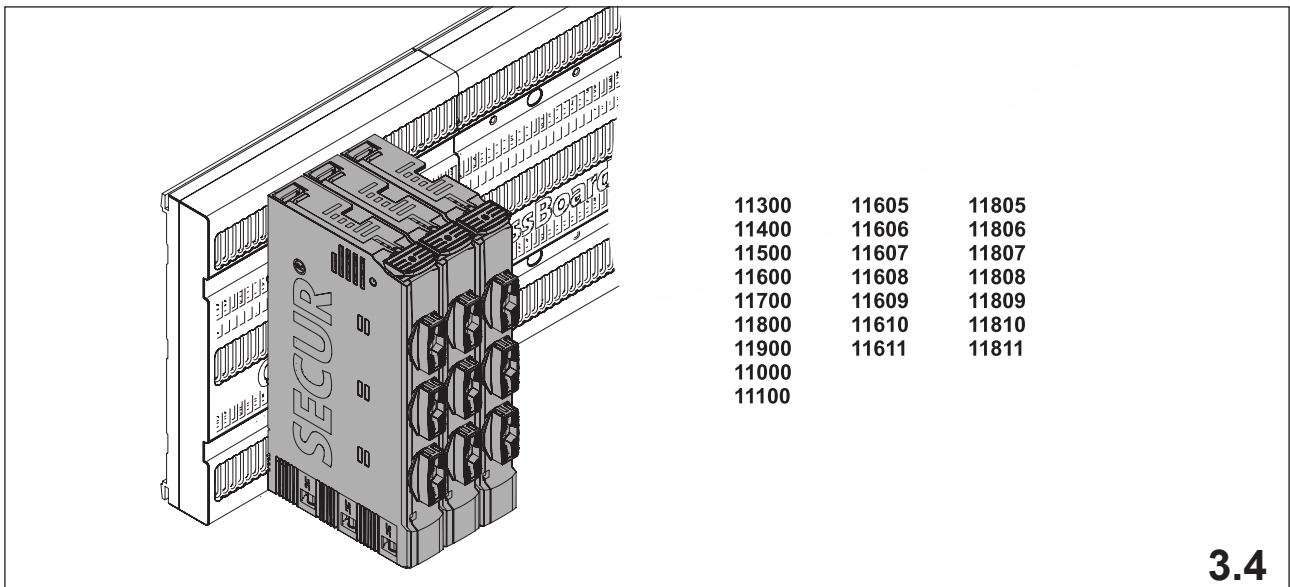

4. Demontage von CrossBoard®
Dismounting from CrossBoard®

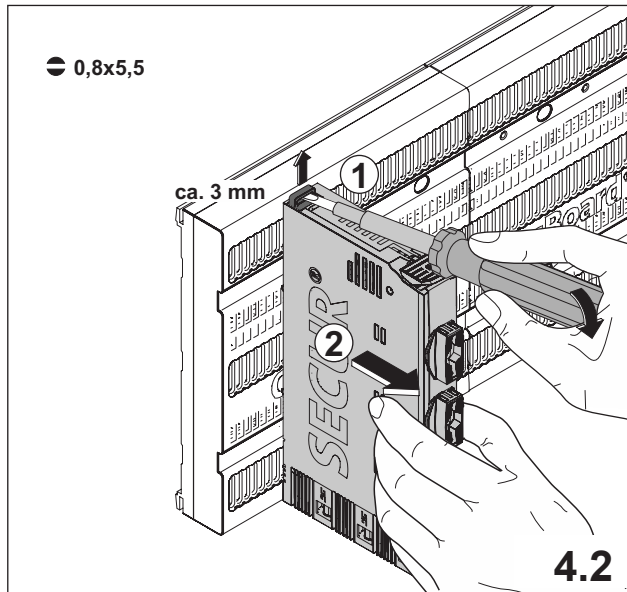
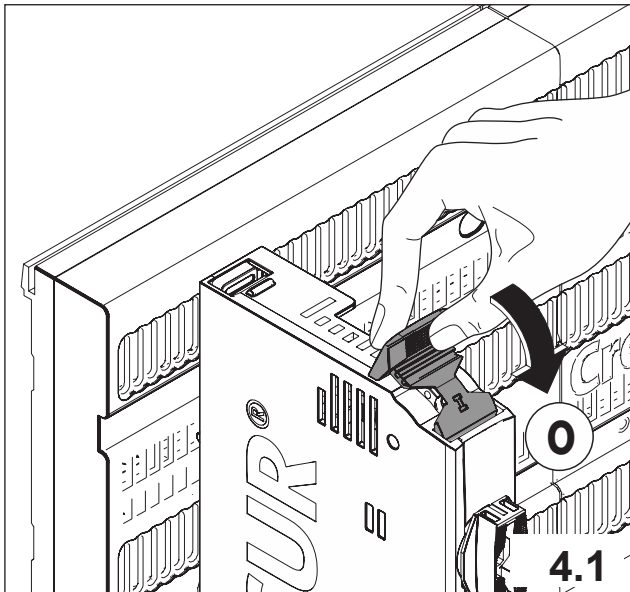

5. Einsetzen der Sicherungen
Insert the fuses

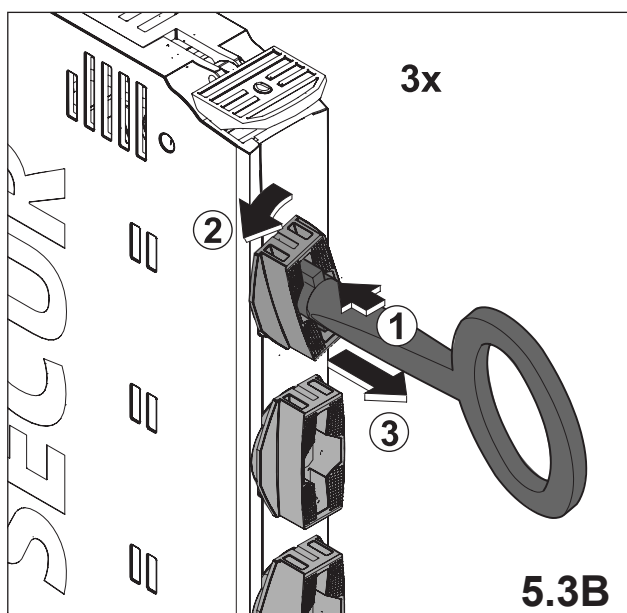
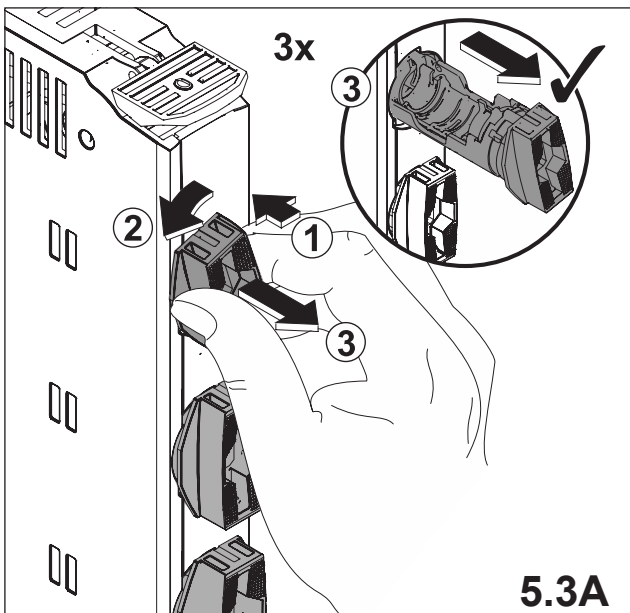
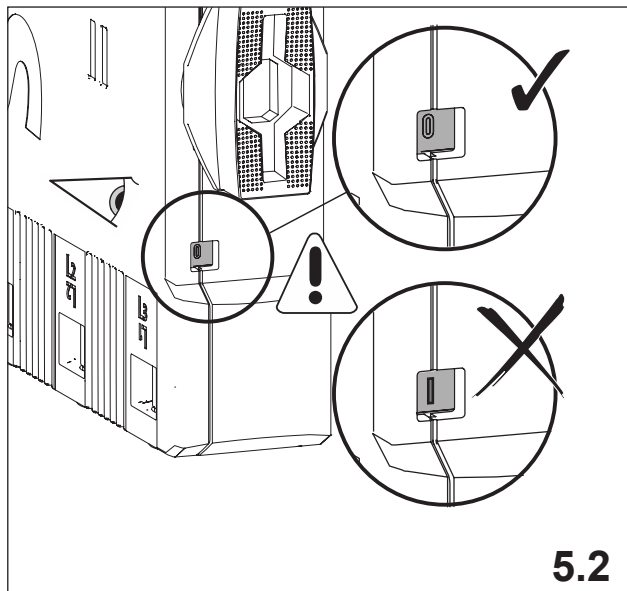
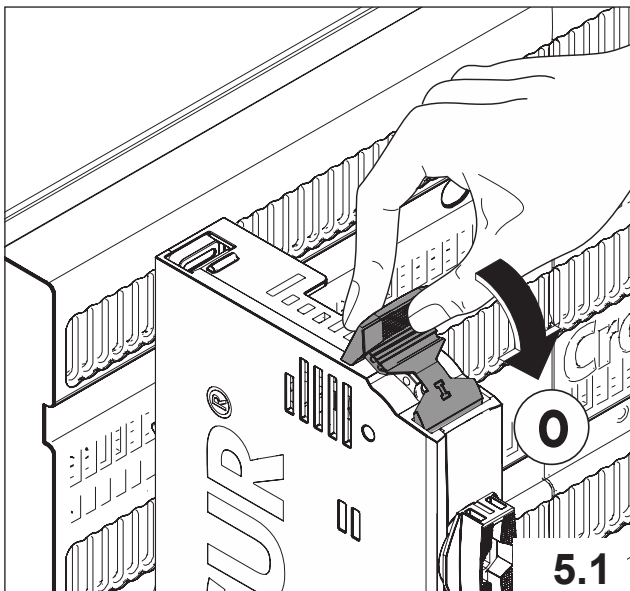

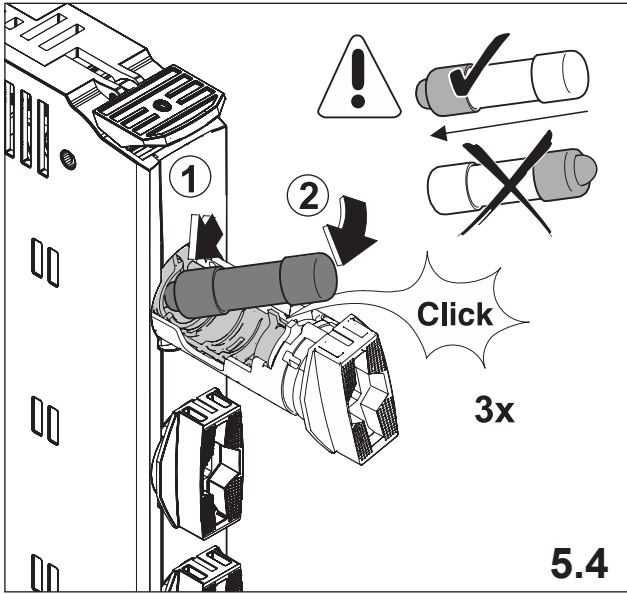

5.4

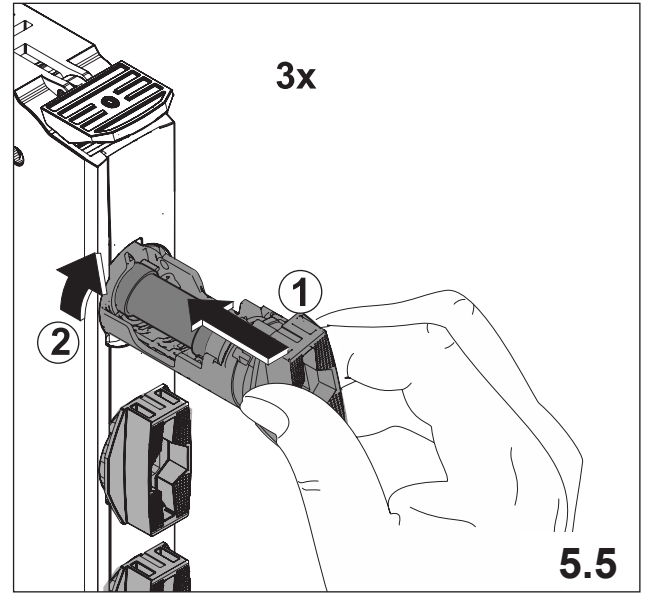

5.5

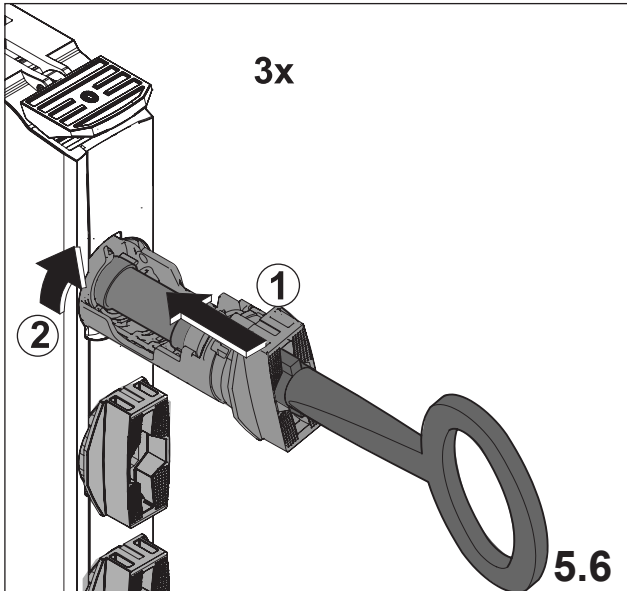

5.6

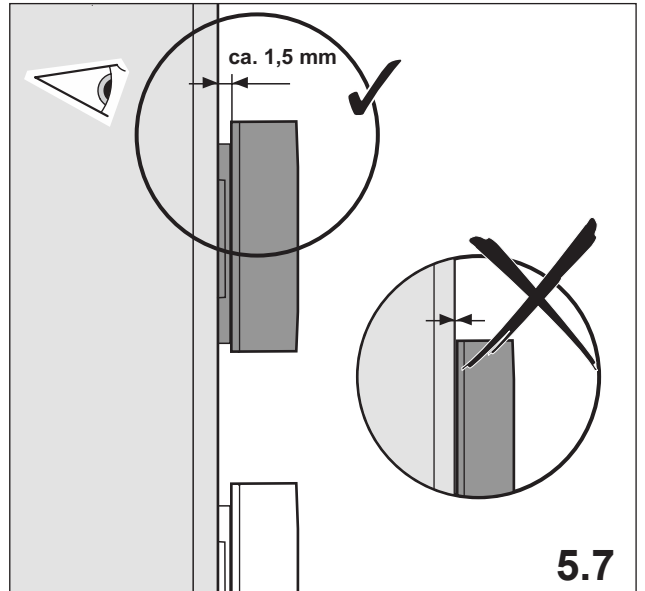

5.7

6. Leitungen anschließen
Connecting the cables

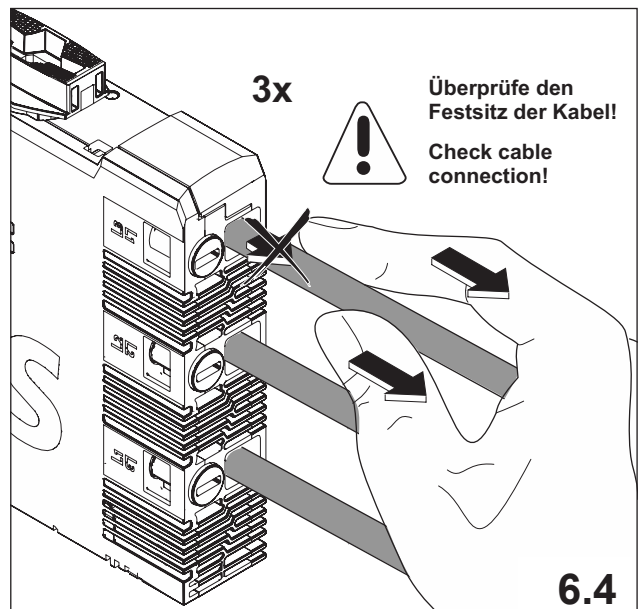
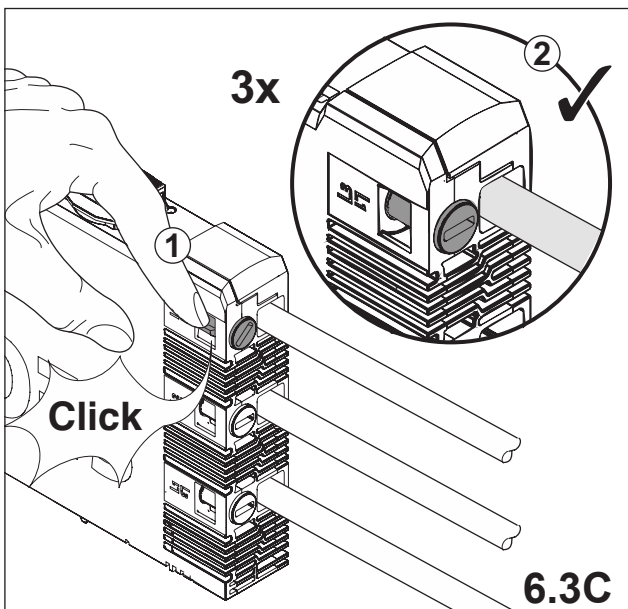
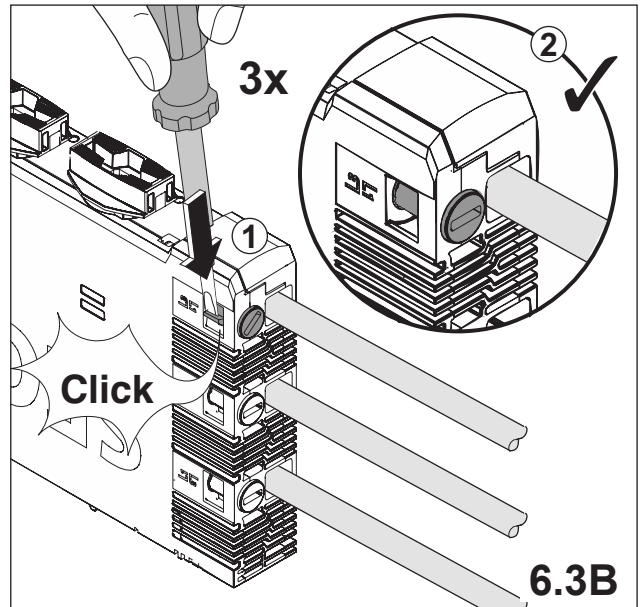
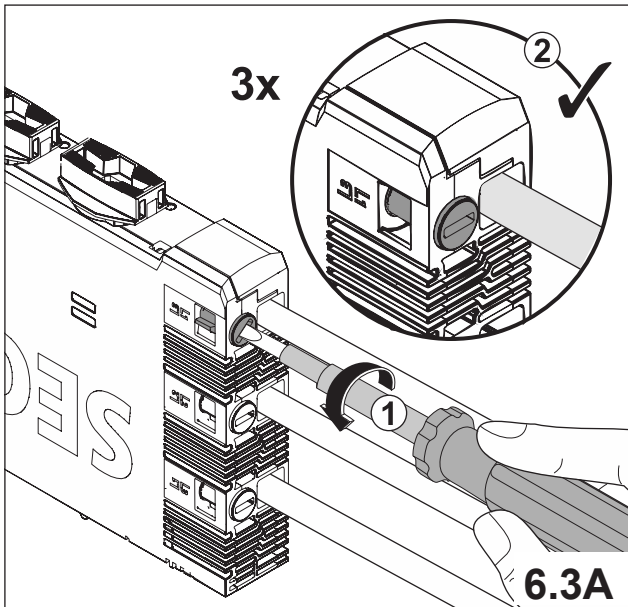
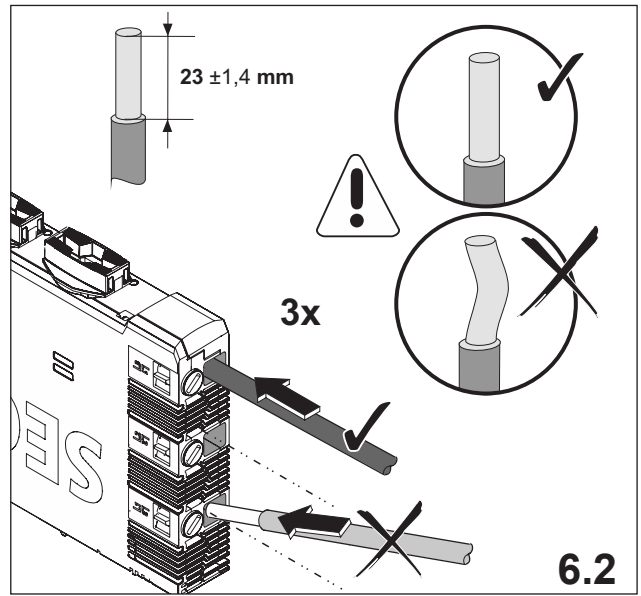
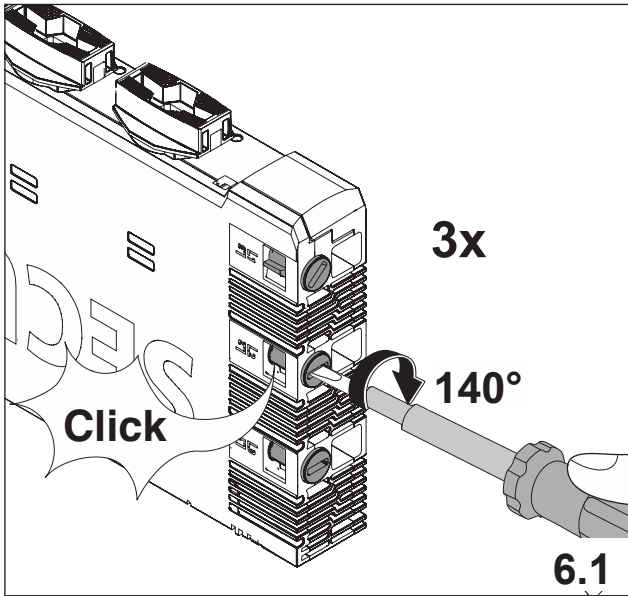

7. Gerät einschalten
Switching on the device

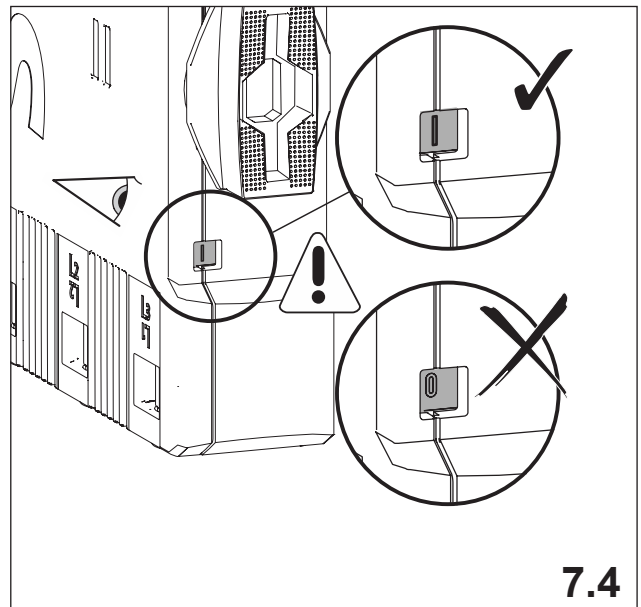
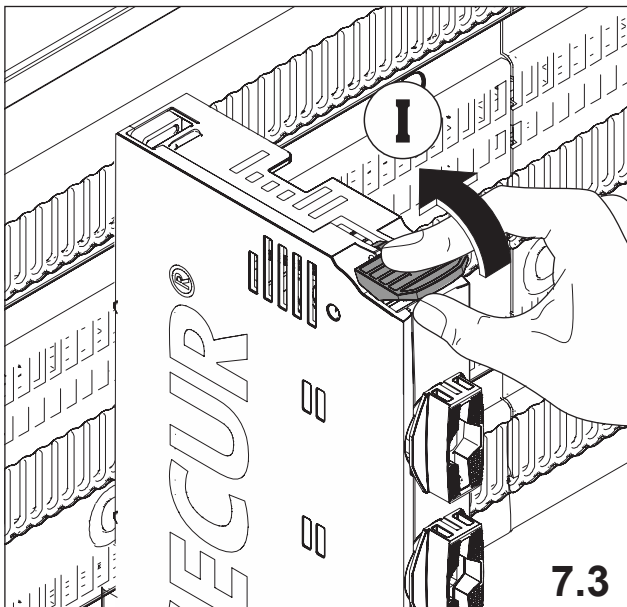
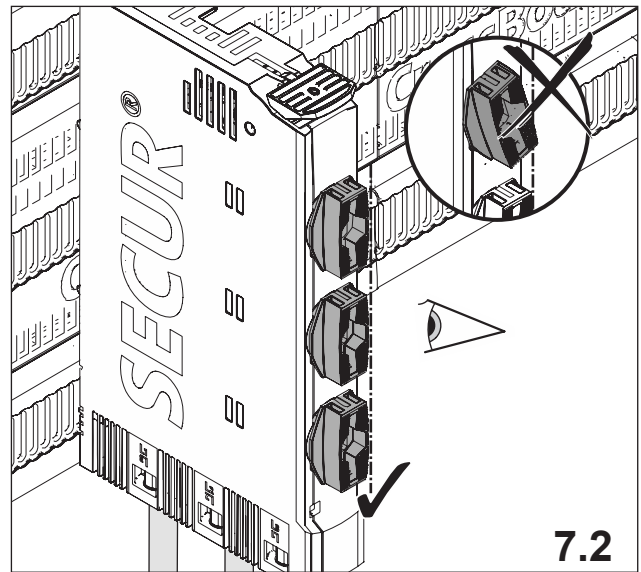
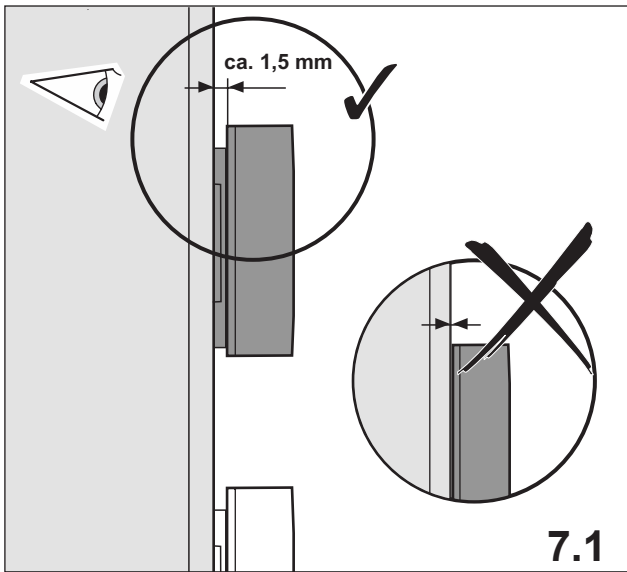

8. Spannungsprüfung
Voltage test

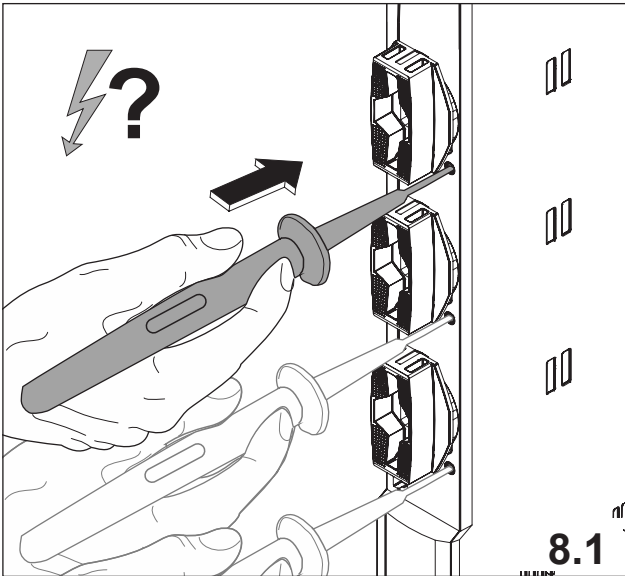

9. Plombieren
Sealing

